

J.B/44



**Illinois Department  
of Transportation**

**Local Public Agency Formal Contract**

Contractor's Name

Stark Excavating, Inc.

Contractor's Address

1805 W. Washington

City

Bloomington

State

IL

Zip Code

61701

STATE OF ILLINOIS

Local Public Agency

Pesotum Township

County

Champaign

Section Number

06-18408-00-SP

Street Name/Road Name

1605 E Main Street, Urbana, IL 61802

Type of Funds

Motor Fuel Tax

☒ CONTRACT BOND (when required)

**For a County and Road District Project**

Submitted/Approved

Highway Commissioner Signature & Date

*Josh Eisemenger* 5/3/23

Submitted/Approved

County Engineer/Superintendent of Highways Signature & Date

*[Signature]* 5/3/23

**For a Municipal Project**

Submitted/Approved/Passed

Signature & Date

Official Title

**Department of Transportation**

☒ Concurrence in approval of award

Regional Engineer Signature & Date

*Kensil A. Garnett* 051923

Local Public Agency	Local Street/Road Name	County	Section Number
Pesotum Township	1605 E Main Street, Urbana, IL 61802	Champaign	06-18408-00-SP

1. THIS AGREEMENT, made and concluded the 27th day of March 2023 between the County of Champaign, known as the party of the first part, and Stark Excavating, Inc., its successor, and assigns, known as the party of the second part.
2. For and in consideration of the payments and agreements mentioned in the Proposal hereto attached, to be made and performed by the party of the first part, and according to the terms expressed in the Bond referring this contract, the party of the second part agrees with said party of the first part, at its own proper cost and expense, to do all the work, furnish all materials and all labor necessary to complete the work in accordance with the plans and specifications hereinafter described, and in full compliance with all of the terms of this contract.
3. It is also understood and agreed that the LPA Formal Contract Proposal, Special Provisions, Affidavit of Illinois Business Office, Apprenticeship or Training Program Certification, and Contract Bond hereto attached, and the Plans for Section 06-18408-00-SP in Pesotum Township, approved by the Illinois Department of Transportation on 01/04/23, are essential documents of this contract and are a part hereof.

4. IN WITNESS WHEREOF, the said parties have executed this contract on the date above mentioned.

Attest: The County of Champaign  
Local Public Agency Type Name of Local Public Agency

Clerk Signature & Date

[Signature] 5-11-23

(SEAL, if required by the LPA)

Party of the First Part Signature & Date

By: [Signature] 05/11/2023

(If a Corporation)

Corporate Name

Stark Excavating, Inc

President, Party of the Second Part Signature & Date

By: [Signature]

(If a Limited Liability Corporation)

LLC Name

Manager or Authorized Member, Party of the Second Part

By:

(If a Partnership)

Partner Signature & Date

Partner Signature & Date

Partners doing Business under the firm name of  
Party of the Second Part

(If an individual)

Party of the Second Part Signature & Date

Attest:

Secretary Signature & Date

[Signature]

(SEAL, if required by the LPA)





## Contract Bond

Local Public Agency	County	Street Name/Road Name	Section Number
Pesotum Township	Champaign	ICRR Crossing, 100N	06-18408-00-SP

Bond Information to be returned to Local Public Agency at 1605 E Main Street Urbana, IL 61802

Complete Address

We, Stark Excavating, Inc. 1805 W Washington St, Bloomington, IL 61701

Contractor's Name and Address

a/an Corporation organized under the laws of the State of Illinois as PRINCIPAL, and  
StateBerkley Insurance Company - 475 Steamboat Rd., Greenwich CT 06830

Surety Name and Address

as SURETY, are held and firmly bound unto the above Local Public Agency (hereafter referred to as "LPA") in the penal sum of Eighty-six thousand, eight hundred thirty dollars.Dollars ( \$86,830.00 ) lawful money of the United States, to be paid to said LPA, the payment of which we bind ourselves, successors and assigns jointly to pay to the LPA this sum under the conditions of this instrument.

WHEREAS, THE CONDITION OF THE FOREGOING OBLIGATION IS SUCH that the said Principal has entered into a written contract with the LPA acting through its awarding authority for the construction of work on the above sections, which contract is hereby referred to and made a part hereof, as if written herein at length, and whereby the said Principal has promised and agreed to perform said work in accordance with the terms of said contract, and has promised to pay all sums of money due for any labor, materials, apparatus, fixtures or machinery furnished to such Principal for the purpose of performing such work and has further agreed to pay all direct and indirect damages to any person, firm, company or corporation to whom any money may be due from the Principal, subcontractor or otherwise for any such labor, materials, apparatus, fixtures or machinery so furnished and that suit may be maintained on such bond by any such person, firm, company or corporation for the recovery of any such money.

NOW, THEREFORE, if the said Principal shall perform said work in accordance with the terms of said contract, and shall pay all sums of money due or to become due for any labor, materials, apparatus, fixtures or machinery furnished to it for the purpose of constructing such work, and shall commence and complete the work within the time prescribed in said contract, and shall pay and discharge all damages, direct and indirect, that may be suffered or sustained on account of such work during the time of the performance thereof and until the said work shall have been accepted, and shall hold the LPA and its awarding authority harmless on account of any such damages and shall in all respects fully and faithfully comply with all the provisions, conditions and requirements of said contract, then this obligation shall be void; otherwise it shall remain in full force and effect.

IN TESTIMONY WHEREOF, the said PRINCIPAL and the said SURETY have caused this instrument to be signed by their respective agents this 8th day of May, 2023  
Day Month and Year

## PRINCIPAL

Company Name

Stark Excavating, Inc

By

Signature &amp; Date

(David K. Stark, Jr. - Vice President)

Attest

Signature &amp; Date

(Ila J. Slagell - Secretary)

Company Name

N/A

By

Signature &amp; Date

N/A

Attest

Signature &amp; Date

N/A

(If PRINCIPAL is a joint venture of two or more contractors, the company names and authorized signature of each contractor must be affixed.)

STATE OF IL

COUNTY OF DOUGLAS

I, Kyrsten N. Cox, a Notary Public in and for said county, do hereby certify that  
Notary Name

David K. Stark, Jr. and Ila J. Slagell

Insert name of Individuals signing on behalf of PRINCIPAL

who is/are each personally known to me to be the same person(s) whose name(s) is/are subscribed to the foregoing instrument on behalf of PRINCIPAL, appeared before me this day in person and acknowledged respectively, that he/she/they signed and delivered said instrument freely and voluntarily for the uses and purposes therein set forth.

Given under my hand and notarial seal this 8th day of May, 2023  
Day Month, Year

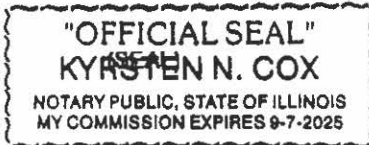

Notary Public Signature & Date

Date commission expires 09/07/2025

SURETY

Name of Surety

Berkley Insurance Company

Title: Attorney in Fact

By:

(Lucas Sherman)

STATE OF IL

COUNTY OF DOUGLAS

I, Kyrsten N. Cox, a Notary Public in and for said county, do hereby certify that  
Notary Name

Lucas Sherman

Insert name of Individuals signing on behalf of SURETY

who is/are each personally known to me to be the same person(s) whose name(s) is/are subscribed to the foregoing instrument on behalf of SURETY, appeared before me this day in person and acknowledged respectively, that he/she/they signed and delivered said instrument freely and voluntarily for the uses and purposes therein set forth.

Given under my hand and notarial seal this 8th day of May, 2023  
Day Month, Year

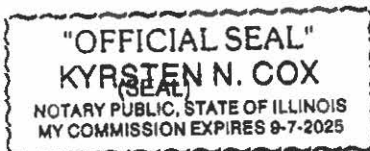

Notary Public Signature & Date

Date commission expires 09/07/2025

Approved this 11th day of May, 2023  
Day Month, Year

Attest:

Local Public Agency Clerk Signature & Date

County

Clerk

Local Public Agency Type

Awarding Authority

Champaign County Board

Awarding Authority Signature & Date



**POWER OF ATTORNEY  
BERKLEY INSURANCE COMPANY  
WILMINGTON, DELAWARE**

**NOTICE:** The warning found elsewhere in this Power of Attorney affects the validity thereof. Please review carefully.

**KNOW ALL MEN BY THESE PRESENTS,** that BERKLEY INSURANCE COMPANY (the "Company"), a corporation duly organized and existing under the laws of the State of Delaware, having its principal office in Greenwich, CT, has made, constituted and appointed, and does by these presents make, constitute and appoint: *Lucas Sherman of CoraMae, Inc. dba Insurance Risk Managers of Champaign, IL* its true and lawful Attorney-in-Fact, to sign its name as surety only as delineated below and to execute, seal, acknowledge and deliver any and all bonds and undertakings, with the exception of Financial Guaranty Insurance, providing that no single obligation shall exceed Fifty Million and 00/100 U.S. Dollars (U.S.\$50,000,000.00), to the same extent as if such bonds had been duly executed and acknowledged by the regularly elected officers of the Company at its principal office in their own proper persons.

This Power of Attorney shall be construed and enforced in accordance with, and governed by, the laws of the State of Delaware, without giving effect to the principles of conflicts of laws thereof. This Power of Attorney is granted pursuant to the following resolutions which were duly and validly adopted at a meeting of the Board of Directors of the Company held on January 25, 2010:

**RESOLVED,** that, with respect to the Surety business written by Berkley Surety, the Chairman of the Board, Chief Executive Officer, President or any Vice President of the Company, in conjunction with the Secretary or any Assistant Secretary are hereby authorized to execute powers of attorney authorizing and qualifying the attorney-in-fact named therein to execute bonds, undertakings, recognizances, or other suretyship obligations on behalf of the Company, and to affix the corporate seal of the Company to powers of attorney executed pursuant hereto; and said officers may remove any such attorney-in-fact and revoke any power of attorney previously granted; and further

**RESOLVED,** that such power of attorney limits the acts of those named therein to the bonds, undertakings, recognizances, or other suretyship obligations specifically named therein, and they have no authority to bind the Company except in the manner and to the extent therein stated; and further

**RESOLVED,** that such power of attorney revokes all previous powers issued on behalf of the attorney-in-fact named; and further

**RESOLVED,** that the signature of any authorized officer and the seal of the Company may be affixed by facsimile to any power of attorney or certification thereof authorizing the execution and delivery of any bond, undertaking, recognizance, or other suretyship obligation of the Company; and such signature and seal when so used shall have the same force and effect as though manually affixed. The Company may continue to use for the purposes herein stated the facsimile signature of any person or persons who shall have been such officer or officers of the Company, notwithstanding the fact that they may have ceased to be such at the time when such instruments shall be issued.

IN WITNESS WHEREOF, the Company has caused these presents to be signed and attested by its appropriate officers and its corporate seal hereunto affixed this 3<sup>rd</sup> day of DECEMBER, 2019.

Attest:

(Seal)

By

Ira S. Lederman  
Executive Vice President & Secretary

Berkley Insurance Company

By

Jeffrey M. Hafter  
Senior Vice President

**WARNING: THIS POWER INVALID IF NOT PRINTED ON BLUE "BERKLEY" SECURITY PAPER.**

STATE OF CONNECTICUT )

) ss:

COUNTY OF FAIRFIELD )

Sworn to before me, a Notary Public in the State of Connecticut, this 3<sup>rd</sup> day of DECEMBER, 2019, by Ira S. Lederman and Jeffrey M. Hafter who are sworn to me to be the Executive Vice President and Secretary, and the Senior Vice President, respectively, of Berkley Insurance Company.

MARIA C RUNDRAKEN  
NOTARY PUBLIC  
CONNECTICUT  
MY COMMISSION EXPIRES  
APRIL 30, 2024

Maria C. Rundracken  
Notary Public, State of Connecticut

**CERTIFICATE**

I, the undersigned, Assistant Secretary of BERKLEY INSURANCE COMPANY, DO HEREBY CERTIFY that the foregoing is a true, correct and complete copy of the original Power of Attorney; that said Power of Attorney has not been revoked or rescinded and that the authority of the Attorney-in-Fact set forth therein, who executed the bond or undertaking to which this Power of Attorney is attached, is in full force and effect as of this date.

Given under my hand and seal of the Company, this 8th day of May, 2023.

(Seal)

Vincent P. Forte  
Vincent P. Forte





# CERTIFICATE OF LIABILITY INSURANCE

DATE (MM/DD/YYYY)

11/02/2022

THIS CERTIFICATE IS ISSUED AS A MATTER OF INFORMATION ONLY AND CONFERS NO RIGHTS UPON THE CERTIFICATE HOLDER. THIS CERTIFICATE DOES NOT AFFIRMATIVELY OR NEGATIVELY AMEND, EXTEND OR ALTER THE COVERAGE AFFORDED BY THE POLICIES BELOW. THIS CERTIFICATE OF INSURANCE DOES NOT CONSTITUTE A CONTRACT BETWEEN THE ISSUING INSURER(S), AUTHORIZED REPRESENTATIVE OR PRODUCER, AND THE CERTIFICATE HOLDER.

**IMPORTANT:** If the certificate holder is an ADDITIONAL INSURED, the policy(ies) must have ADDITIONAL INSURED provisions or be endorsed. If SUBROGATION IS WAIVED, subject to the terms and conditions of the policy, certain policies may require an endorsement. A statement on this certificate does not confer rights to the certificate holder in lieu of such endorsement(s).

<b>PRODUCER</b> Insurance Risk Managers 2104 Windsor Place Suite B Champaign IL 61820		<b>CONTACT NAME:</b> Luke Sherman <b>PHONE (A/C, No, Ext):</b> (217) 239-3755 <b>FAX (A/C, No):</b> (217) 239-3769 <b>E-MAIL ADDRESS:</b> service@imagency.com															
<b>INSURED</b> Stark Excavating, Inc 1805 W Washington St Bloomington IL 61701-3703		<b>INSURER(S) AFFORDING COVERAGE</b> <table border="1"><thead><tr><th>INSURER</th><th>NAIC #</th></tr></thead><tbody><tr><td>INSURER A: Motorist Commercial Mutual Insurance</td><td>13331</td></tr><tr><td>INSURER B: BrickStreet Mutual Insurance Company</td><td>12372</td></tr><tr><td>INSURER C: Great American Insurance Company</td><td>16691</td></tr><tr><td>INSURER D: Westchester Surplus Lines Insurance</td><td>10172</td></tr><tr><td>INSURER E: Selective Insurance Company</td><td>19259</td></tr><tr><td>INSURER F:</td><td></td></tr></tbody></table>		INSURER	NAIC #	INSURER A: Motorist Commercial Mutual Insurance	13331	INSURER B: BrickStreet Mutual Insurance Company	12372	INSURER C: Great American Insurance Company	16691	INSURER D: Westchester Surplus Lines Insurance	10172	INSURER E: Selective Insurance Company	19259	INSURER F:	
INSURER	NAIC #																
INSURER A: Motorist Commercial Mutual Insurance	13331																
INSURER B: BrickStreet Mutual Insurance Company	12372																
INSURER C: Great American Insurance Company	16691																
INSURER D: Westchester Surplus Lines Insurance	10172																
INSURER E: Selective Insurance Company	19259																
INSURER F:																	

**COVERAGES****CERTIFICATE NUMBER:** 23-24 Master**REVISION NUMBER:**

THIS IS TO CERTIFY THAT THE POLICIES OF INSURANCE LISTED BELOW HAVE BEEN ISSUED TO THE INSURED NAMED ABOVE FOR THE POLICY PERIOD INDICATED. NOTWITHSTANDING ANY REQUIREMENT, TERM OR CONDITION OF ANY CONTRACT OR OTHER DOCUMENT WITH RESPECT TO WHICH THIS CERTIFICATE MAY BE ISSUED OR MAY PERTAIN, THE INSURANCE AFFORDED BY THE POLICIES DESCRIBED HEREIN IS SUBJECT TO ALL THE TERMS, EXCLUSIONS AND CONDITIONS OF SUCH POLICIES. LIMITS SHOWN MAY HAVE BEEN REDUCED BY PAID CLAIMS.

INSR LTR	TYPE OF INSURANCE	ADDL SUBR INSD WVD	POLICY NUMBER	POLICY EFF (MM/DD/YYYY)	POLICY EXP (MM/DD/YYYY)	LIMITS														
A	<input checked="" type="checkbox"/> COMMERCIAL GENERAL LIABILITY <input type="checkbox"/> CLAIMS-MADE <input checked="" type="checkbox"/> OCCUR GEN'L AGGREGATE LIMIT APPLIES PER: <input type="checkbox"/> POLICY <input checked="" type="checkbox"/> PROJECT <input type="checkbox"/> LOC OTHER:	Y	5000151698	01/01/2023	01/01/2024	<table border="1"><tr><td>EACH OCCURRENCE</td><td>\$ 1,000,000</td></tr><tr><td>DAMAGE TO RENTED PREMISES (Ea occurrence)</td><td>\$ 500,000</td></tr><tr><td>MED EXP (Any one person)</td><td>\$ 10,000</td></tr><tr><td>PERSONAL &amp; ADV INJURY</td><td>\$ 1,000,000</td></tr><tr><td>GENERAL AGGREGATE</td><td>\$ 2,000,000</td></tr><tr><td>PRODUCTS - COMP/OP AGG</td><td>\$ 2,000,000</td></tr><tr><td></td><td>\$</td></tr></table>	EACH OCCURRENCE	\$ 1,000,000	DAMAGE TO RENTED PREMISES (Ea occurrence)	\$ 500,000	MED EXP (Any one person)	\$ 10,000	PERSONAL & ADV INJURY	\$ 1,000,000	GENERAL AGGREGATE	\$ 2,000,000	PRODUCTS - COMP/OP AGG	\$ 2,000,000		\$
	EACH OCCURRENCE	\$ 1,000,000																		
	DAMAGE TO RENTED PREMISES (Ea occurrence)	\$ 500,000																		
	MED EXP (Any one person)	\$ 10,000																		
PERSONAL & ADV INJURY	\$ 1,000,000																			
GENERAL AGGREGATE	\$ 2,000,000																			
PRODUCTS - COMP/OP AGG	\$ 2,000,000																			
	\$																			
A	<input checked="" type="checkbox"/> AUTOMOBILE LIABILITY <input checked="" type="checkbox"/> ANY AUTO <input type="checkbox"/> OWNED AUTOS ONLY <input type="checkbox"/> SCHEDULED AUTOS <input type="checkbox"/> HIRED AUTOS ONLY <input type="checkbox"/> NON-OWNED AUTOS ONLY		5000151699	01/01/2023	01/01/2024	<table border="1"><tr><td>COMBINED SINGLE LIMIT (Ea accident)</td><td>\$ 1,000,000</td></tr><tr><td>BODILY INJURY (Per person)</td><td>\$</td></tr><tr><td>BODILY INJURY (Per accident)</td><td>\$</td></tr><tr><td>PROPERTY DAMAGE (Per accident)</td><td>\$</td></tr><tr><td></td><td>\$</td></tr></table>	COMBINED SINGLE LIMIT (Ea accident)	\$ 1,000,000	BODILY INJURY (Per person)	\$	BODILY INJURY (Per accident)	\$	PROPERTY DAMAGE (Per accident)	\$		\$				
	COMBINED SINGLE LIMIT (Ea accident)	\$ 1,000,000																		
	BODILY INJURY (Per person)	\$																		
	BODILY INJURY (Per accident)	\$																		
PROPERTY DAMAGE (Per accident)	\$																			
	\$																			
A	<input checked="" type="checkbox"/> UMBRELLA LIAB <input checked="" type="checkbox"/> OCCUR <input type="checkbox"/> EXCESS LIAB <input type="checkbox"/> CLAIMS-MADE DED <input checked="" type="checkbox"/> RETENTION \$ 0		5000151849	01/01/2023	01/01/2024	<table border="1"><tr><td>EACH OCCURRENCE</td><td>\$ 5,000,000</td></tr><tr><td>AGGREGATE</td><td>\$ 5,000,000</td></tr><tr><td></td><td>\$</td></tr></table>	EACH OCCURRENCE	\$ 5,000,000	AGGREGATE	\$ 5,000,000		\$								
	EACH OCCURRENCE	\$ 5,000,000																		
	AGGREGATE	\$ 5,000,000																		
	\$																			
B	WORKERS COMPENSATION AND EMPLOYERS' LIABILITY ANY PROPRIETOR/PARTNER/EXECUTIVE OFFICER/MEMBER EXCLUDED? (Mandatory in NH) If yes, describe under DESCRIPTION OF OPERATIONS below	Y/N <input checked="" type="checkbox"/> N	WCB1033288	12/31/2022	12/31/2023	<table border="1"><tr><td><input checked="" type="checkbox"/> PER STATUTE <input type="checkbox"/> OTH-ER</td><td></td></tr><tr><td>E.L. EACH ACCIDENT</td><td>\$ 1,000,000</td></tr><tr><td>E.L. DISEASE - EA EMPLOYEE</td><td>\$ 1,000,000</td></tr><tr><td>E.L. DISEASE - POLICY LIMIT</td><td>\$ 1,000,000</td></tr></table>	<input checked="" type="checkbox"/> PER STATUTE <input type="checkbox"/> OTH-ER		E.L. EACH ACCIDENT	\$ 1,000,000	E.L. DISEASE - EA EMPLOYEE	\$ 1,000,000	E.L. DISEASE - POLICY LIMIT	\$ 1,000,000						
	<input checked="" type="checkbox"/> PER STATUTE <input type="checkbox"/> OTH-ER																			
	E.L. EACH ACCIDENT	\$ 1,000,000																		
	E.L. DISEASE - EA EMPLOYEE	\$ 1,000,000																		
E.L. DISEASE - POLICY LIMIT	\$ 1,000,000																			
C	Excess Liability		TUE3326033	01/01/2023	01/01/2024	<table border="1"><tr><td>Each Occurrence</td><td>\$5,000,000</td></tr><tr><td>Aggregate</td><td>\$5,000,000</td></tr></table>	Each Occurrence	\$5,000,000	Aggregate	\$5,000,000										
Each Occurrence	\$5,000,000																			
Aggregate	\$5,000,000																			

**DESCRIPTION OF OPERATIONS / LOCATIONS / VEHICLES (ACORD 101, Additional Remarks Schedule, may be attached if more space is required)**

Champaign County Highway Department is included as additional insured with respect to general liability, as required by written contract. Umbrella follows form. The coverage and limits conform to the minimums required by Article 107.27 of the Standard Specifications for Road and Bridge Construction.

**CERTIFICATE HOLDER****CANCELLATION**

Champaign County Highway Department 1605 E Main St Urbana IL 61802	<b>SHOULD ANY OF THE ABOVE DESCRIBED POLICIES BE CANCELLED BEFORE THE EXPIRATION DATE THEREOF, NOTICE WILL BE DELIVERED IN ACCORDANCE WITH THE POLICY PROVISIONS.</b> <b>AUTHORIZED REPRESENTATIVE</b> 
--	--

© 1988-2015 ACORD CORPORATION. All rights reserved.



# CERTIFICATE OF LIABILITY INSURANCE

DATE (MM/DD/YYYY)

05/04/2023

THIS CERTIFICATE IS ISSUED AS A MATTER OF INFORMATION ONLY AND CONFERS NO RIGHTS UPON THE CERTIFICATE HOLDER. THIS CERTIFICATE DOES NOT AFFIRMATIVELY OR NEGATIVELY AMEND, EXTEND OR ALTER THE COVERAGE AFFORDED BY THE POLICIES BELOW. THIS CERTIFICATE OF INSURANCE DOES NOT CONSTITUTE A CONTRACT BETWEEN THE ISSUING INSURER(S), AUTHORIZED REPRESENTATIVE OR PRODUCER, AND THE CERTIFICATE HOLDER.

**IMPORTANT:** If the certificate holder is an **ADDITIONAL INSURED**, the policy(ies) must have **ADDITIONAL INSURED** provisions or be endorsed. If **SUBROGATION** IS WAIVED, subject to the terms and conditions of the policy, certain policies may require an endorsement. A statement on this certificate does not confer rights to the certificate holder in lieu of such endorsement(s).

<b>PRODUCER</b> Insurance Risk Managers 2104 Windsor Place Suite B Champaign IL 61820	<b>CONTACT NAME:</b> Luke Sherman <b>PHONE (A/C, No, Ext):</b> (217) 239-3755 <b>E-MAIL ADDRESS:</b> service@irmagency.com <b>FAX (A/C, No):</b> (217) 239-3769														
<b>INSURED</b> Stark Excavating, Inc 1805 W Washington St Bloomington IL 61701-3703	<table border="1"><thead><tr><th>INSURER(S) AFFORDING COVERAGE</th><th>NAIC #</th></tr></thead><tbody><tr><td>INSURER A: Motorist Commercial Mutual Insurance</td><td>13331</td></tr><tr><td>INSURER B: BrickStreet Mutual Insurance Company</td><td>12372</td></tr><tr><td>INSURER C: Great American Insurance Company</td><td>16691</td></tr><tr><td>INSURER D: Westchester Surplus Lines Insurance</td><td>10172</td></tr><tr><td>INSURER E: Selective Insurance Company</td><td>19259</td></tr><tr><td>INSURER F:</td><td></td></tr></tbody></table>	INSURER(S) AFFORDING COVERAGE	NAIC #	INSURER A: Motorist Commercial Mutual Insurance	13331	INSURER B: BrickStreet Mutual Insurance Company	12372	INSURER C: Great American Insurance Company	16691	INSURER D: Westchester Surplus Lines Insurance	10172	INSURER E: Selective Insurance Company	19259	INSURER F:	
INSURER(S) AFFORDING COVERAGE	NAIC #														
INSURER A: Motorist Commercial Mutual Insurance	13331														
INSURER B: BrickStreet Mutual Insurance Company	12372														
INSURER C: Great American Insurance Company	16691														
INSURER D: Westchester Surplus Lines Insurance	10172														
INSURER E: Selective Insurance Company	19259														
INSURER F:															

**COVERAGES****CERTIFICATE NUMBER:** 23-24 Master**REVISION NUMBER:**

THIS IS TO CERTIFY THAT THE POLICIES OF INSURANCE LISTED BELOW HAVE BEEN ISSUED TO THE INSURED NAMED ABOVE FOR THE POLICY PERIOD INDICATED. NOTWITHSTANDING ANY REQUIREMENT, TERM OR CONDITION OF ANY CONTRACT OR OTHER DOCUMENT WITH RESPECT TO WHICH THIS CERTIFICATE MAY BE ISSUED OR MAY PERTAIN, THE INSURANCE AFFORDED BY THE POLICIES DESCRIBED HEREIN IS SUBJECT TO ALL THE TERMS, EXCLUSIONS AND CONDITIONS OF SUCH POLICIES. LIMITS SHOWN MAY HAVE BEEN REDUCED BY PAID CLAIMS.

INSR LTR	TYPE OF INSURANCE	ADDL INSD	SUBR WVD	POLICY NUMBER	POLICY EFF (MM/DD/YYYY)	POLICY EXP (MM/DD/YYYY)	LIMITS
A	<input checked="" type="checkbox"/> <b>COMMERCIAL GENERAL LIABILITY</b> <input type="checkbox"/> CLAIMS-MADE <input checked="" type="checkbox"/> OCCUR GEN'L AGGREGATE LIMIT APPLIES PER: <input type="checkbox"/> POLICY <input checked="" type="checkbox"/> PROJECT <input checked="" type="checkbox"/> LOC OTHER:			5000151698	01/01/2023	01/01/2024	EACH OCCURRENCE \$ 1,000,000 DAMAGE TO RENTED PREMISES (Ea occurrence) \$ 500,000 MED EXP (Any one person) \$ 10,000 PERSONAL & ADV INJURY \$ 1,000,000 GENERAL AGGREGATE \$ 2,000,000 PRODUCTS - COMP/OP AGG \$ 2,000,000
A	<input checked="" type="checkbox"/> <b>AUTOMOBILE LIABILITY</b> <input checked="" type="checkbox"/> ANY AUTO OWNED AUTOS ONLY <input type="checkbox"/> SCHEDULED AUTOS HIRED AUTOS ONLY <input type="checkbox"/> NON-OWNED AUTOS ONLY			5000151699	01/01/2023	01/01/2024	COMBINED SINGLE LIMIT (Ea accident) \$ 1,000,000 BODILY INJURY (Per person) \$ BODILY INJURY (Per accident) \$ PROPERTY DAMAGE (Per accident) \$
A	<input checked="" type="checkbox"/> <b>UMBRELLA LIAB</b> <input checked="" type="checkbox"/> OCCUR <input type="checkbox"/> EXCESS LIAB <input type="checkbox"/> CLAIMS-MADE DED <input checked="" type="checkbox"/> RETENTION \$ 0			5000151849	01/01/2023	01/01/2024	EACH OCCURRENCE \$ 5,000,000 AGGREGATE \$ 5,000,000
B	<b>WORKERS' COMPENSATION AND EMPLOYERS' LIABILITY</b> ANY PROPRIETOR/PARTNER/EXECUTIVE OFFICER/MEMBER EXCLUDED? (Mandatory in NH) If yes, describe under DESCRIPTION OF OPERATIONS below	Y/N <input checked="" type="checkbox"/> N	N/A	WCB1033288	12/31/2022	12/31/2023	<input checked="" type="checkbox"/> PER STATUTE <input type="checkbox"/> OTHER E.L. EACH ACCIDENT \$ 1,000,000 E.L. DISEASE - EA EMPLOYEE \$ 1,000,000 E.L. DISEASE - POLICY LIMIT \$ 1,000,000
C	Excess Liability			TUE3326033	01/01/2023	01/01/2024	Each Occurrence \$5,000,000 Aggregate \$5,000,000

**DESCRIPTION OF OPERATIONS / LOCATIONS / VEHICLES** (ACORD 101, Additional Remarks Schedule, may be attached if more space is required)

RRPL Policy: Carrier: Hudson Insurance Company, NAIC #25054, Policy #RRP015199613647, Effective 5/8/23-9/15/23, Limits \$5,000,000 Occurrence/ \$10,000,000 Aggregate

RE: ICRR Crossing @100 N - TR 307 S of Pesotum

**CERTIFICATE HOLDER****CANCELLATION**

Illinois Central Railroad Comp. Manager Engineering Service 17641 S Ashland Ave  Homewood IL 60430-1345	SHOULD ANY OF THE ABOVE DESCRIBED POLICIES BE CANCELLED BEFORE THE EXPIRATION DATE THEREOF, NOTICE WILL BE DELIVERED IN ACCORDANCE WITH THE POLICY PROVISIONS.  AUTHORIZED REPRESENTATIVE 
--	--

© 1988-2015 ACORD CORPORATION. All rights reserved.



COVER SHEET

Proposal Submitted By:

Contractor's Name

Stark Excavating, Inc.

Contractor's Address

1805 W. Washington St.

City

Bloomington

State

IL

Zip Code

61701

STATE OF ILLINOIS

Local Public Agency

Pesotum Township

County

Champaign

Section Number

06-18408-00-SP

Route(s) (Street/Road Name)

ICRR Crossing, 100N (TR 307)(AAR/DOT #289 106W)

Type of Funds

MFT FUNDS

☐ Proposal Only ☒ Proposal and Plans ☐ Proposal only, plans are separate

Submitted/Approved

For Local Public Agency:

For a County and Road District Project

Submitted/Approved

Highway Commissioner Signature

Date

Josh Erseminger

12/24/22

Submitted/Approved

County Engineer/Superintendent of Highways Date

[Signature]

12/24/22

For a Municipal Project

Submitted/Approved/Passed

Signature

Date

[Signature]

[Date]

Official Title

[Title]

Department of Transportation

Released for bid based on limited review

Regional Engineer Signature

Date

[Signature]

01/04/23

Note: All proposal documents, including Proposal Guaranty Checks or Proposal Bid Bonds, should be stapled together to prevent loss when bids are processed.



Local Public Agency	County	Section Number	Route(s) (Street/Road Name)
Pesotum Township	Champaign	06-18408-00-SP	ICRR Crossing, 100N (TR 307)(

### NOTICE TO BIDDERS

Sealed proposals for the project described below will be received at the office of the County Engineer at  
1605 East Main St, Urbana, IL. 61802 until 10:00AM on 03/02/2023  
 Address Time Date

Sealed proposals will be opened and read publicly at the office of the County Engineer at  
1605 East Main St, Urbana, IL. 61802 at 10:00AM on 03/02/2023  
 Address Time Date

### DESCRIPTION OF WORK

Location	Project Length
On the Illinois Central RR crossing at TR 307 (100N), south of Pesotum, IL	700.00 Feet

#### Proposed Improvement

This improvement shall upgrade the railroad crossing to a fully signalized crossing. The roadway shall be widened throughout the crossing and tapered back to its existing width. (AAR/DOT #289 106W)

1. Plans and proposal forms will be available in the office of

the County Engineer at 1605 East Main St, Urbana, IL. 61802

#### 2. ☒ Prequalification

If checked, the 2 apparent as read low bidders must file within 24 hours after the letting an "Affidavit of Availability" (Form BC 57) in triplicate, showing all uncompleted contracts awarded to them and all low bids pending award for Federal, State, County, Municipal and private work. One original shall be filed with the Awarding Authority and two originals with the IDOT District Office.

3. The Awarding Authority reserves the right to waive technicalities and to reject any or all proposals as provided in BLRS Special Provision for Bidding Requirements and Conditions for Contract Proposals.
4. The following BLR Forms shall be returned by the bidder to the Awarding Authority:
  - a. Local Public Agency Formal Contract Proposal (BLR 12200)
  - b. Schedule of Prices (BLR 12201)
  - c. Proposal Bid Bond (BLR 12230) (if applicable)
  - d. Apprenticeship or Training Program Certification (BLR 12325) (do not use for project with Federal funds.)
  - e. Affidavit of Illinois Business Office (BLR 12326) (do not use for project with Federal funds)
5. The quantities appearing in the bid schedule are approximate and are prepared for the comparison of bids. Payment to the Contractor will be made only for the actual quantities of work performed and accepted or materials furnished according to the contract. The scheduled quantities of work to be done and materials to be furnished may be increased, decreased or omitted as hereinafter provided.
6. Submission of a bid shall be conclusive assurance and warranty the bidder has examined the plans and understands all requirements for the performance of work. The bidder will be responsible for all errors in the proposal resulting from failure or neglect to conduct an in depth examination. The Awarding Authority will, in no case, be responsible for any costs, expenses, losses or changes in anticipated profits resulting from such failure or neglect of the bidder.
7. The bidder shall take no advantage of any error or omission in the proposal and advertised contract.
8. If a special envelope is supplied by the Awarding Authority, each proposal should be submitted in that envelope furnished by the Awarding Agency and the blank spaces on the envelope shall be filled in correctly to clearly indicate its contents. When an envelope other than the special one furnished by the Awarding Authority is used, it shall be marked to clearly indicate its contents. When sent by mail, the sealed proposal shall be addressed to the Awarding Authority at the address and in care of the official in whose office the bids are to be received. All proposals shall be filed prior to the time and at the place specified in the Notice to Bidders. Proposals received after the time specified will be returned to the bidder unopened.
9. Permission will be given to a bidder to withdraw a proposal if the bidder makes the request in writing or in person before the time for opening proposals.

Local Public Agency	County	Section Number	Route(s) (Street/Road Name)
Pesotum Township	Champaign	06-18408-00-SP	ICRR Crossing, 100N (TR 307)(

### PROPOSAL

- Proposal of Stark Excavating, Inc.  

Contractor's Name

1805 W. Washington St. Bloomington, IL 61701  

Contractor's Address
- The plans for the proposed work are those prepared by the Champaign County Hwy Dept.  
and approved by the Department of Transportation on \_\_\_\_\_.
- The specifications referred to herein are those prepared by the Department of Transportation and designated as "Standard Specifications for Road and Bridge Construction" and the "Supplemental Specifications and Recurring Special Provisions" thereto, adopted and in effect on the date of invitation for bids.
- The undersigned agrees to accept, as part of the contract, the applicable Special Provisions indicated on the "Check Sheet for Recurring Special Provisions" contained in this proposal.
- The undersigned agrees to complete the work within 20 working days or by \_\_\_\_\_ unless additional time is granted in accordance with the specifications.
- The successful bidder at the time of execution of the contract will be required to deposit a contract bond for the full amount of the award. When a contract bond is not required, the proposal guaranty check will be held in lieu thereof. If this proposal is accepted and the undersigned fails to execute a contract and contract bond as required, it is hereby agreed that the Bid Bond of check shall be forfeited to the Awarding Authority.
- Each pay item should have a unit price and a total price. If no total price is shown or if there is a discrepancy between the products of the unit price multiplied by the quantity, the unit price shall govern. If a unit price is omitted, the total price will be divided by the quantity in order to establish a unit price. A bid may be declared unacceptable if neither a unit price nor a total price is shown.
- The undersigned submits herewith the schedule of prices on BLR 12201 covering the work to be performed under this contract.
- The undersigned further agrees that if awarded the contract for the sections contained in the combinations on BLR 12201, the work shall be in accordance with the requirements of each individual proposal for the multiple bid specified in the Schedule for Multiple Bids below.
- A proposal guaranty in the proper amount, as specified in BLRS Special Provision for Bidding Requirements and Conditions for Contract Proposals, will be required. Bid Bonds \_\_\_\_\_ be allowed as a proposal guaranty. Accompanying this proposal is either a bid bond, if allowed, on Department form BLR 12230 or a proposal guaranty check, complying with the specifications, made payable to: Champaign County Treasurer of \_\_\_\_\_  
The amount of the check is Bid Bond- 5% ( 5% Bid Bond ).

#### Attach Cashier's Check or Certified Check Here

In the event that one proposal guaranty check is intended to cover two or more bid proposals, the amount must be equal to the sum of the proposal guaranties which would be required for each individual bid proposal. If the proposal guaranty check is placed in another bid proposal, state below where it may be found.

The proposal guaranty check will be found in the bid proposal for: Section Number 06-18408-00-SP



Contractor's Name

Stark Excavating, Inc.

Contractor's Address

1805 W. Washington St.

City

Bloomington

State

IL

Zip Code

61701

Local Public Agency

Pesotum Township

County

Champaign

Section Number

06-18408-00-SP

Route(s) (Street/Road Name)

ICRR Crossing AAR/DOT #289 106W @ TR 307 (100N)

Schedule for Multiple Bids

Combination Letter	Section Included in Combinations	Total

Schedule for Single Bid

(For complete information covering these items, see plans and specifications.)

Item Number	Items	Unit	Quantity	Unit Price	Total
1	Furnished Excavation	Cu Yd.	370.0		
2	Sub Gran Embankment, Spec	Ton	500.0		
3	Seal Coat Aggregate	Ton	15.0		
4	Cover Coat Aggregate	Ton	30.0		
5	Scarify Existing Surface	Sq Yd.	1050.0		
6	Bit Matl (Prime MC-30)	Ton	2.0		
7	Bit Matl (Seal and Cover)	Ton	4.0		
8	RR Liability Insurance	L Sum	1.0		
9	Traff Cont & Protection	L Sum	1.0		
Bidder's Total Proposal					86,830.00

1. Each pay item should have a unit price and a total price.
2. If no total price is shown or if there is a discrepancy between the product of the unit price multiplied by the quantity, the unit price shall govern.
3. If a unit price is omitted, the total price will be divided by the quantity in order to establish a unit price.
4. A bid may be declared unacceptable if neither a unit price or total price is shown.



<====CONTRACTOR NUMBER

CONTRACTOR NAME====> STARK EXCAVATING, INC.

COUNTY(IES)=====> CHAMPAIGN

SECTION=====> 06-18408-00-SP

LETTING DATE=====>

ITEM NUMBER=====>

<====CONTRACT NUMBER

TOTAL QUANTITY  
1,973.000

BLANK PRICES 0

PAY ITEMS 9 TOTAL BID \$86,830.00

<u>PIN</u>	<u>PAY ITEM DESCRIPTION</u>	<u>U OF M</u>	<u>QUANTITY</u>	<u>X</u>	<u>UNIT PRICE</u>	<u>=</u>	<u>TOTAL PRICE</u>
1	FURNISHED EXCAVATION	CUYD	370.000		47.50		\$17,575.00
2	SUB GRAN EMBANKMENT, SPECL	TON	500.000		40.00		\$20,000.00
3	SEAL COAT AGGREGATE	TON	15.000		762.00		\$11,430.00
4	COVER COAT AGGREGATE	TON	30.000		370.00		\$11,100.00
5	SCARIFY EXISTING SURFACE	SQYD	1,050.000		2.70		\$2,835.00
6	BIT MATL (PRIME MC-30)	TON	2.000		2,844.00		\$5,688.00
7	BIT MATL (SEAL AND COVER)	TON	4.000		1,838.00		\$7,352.00
8	RR LIABILITY INSURANCE	LSUM	1.000		4,250.00		\$4,250.00
9	TRAFF CONT & PROTECTION	LSUM	1.000		6,600.00		\$6,600.00



Route	TR 307 (100N/990E)
Section	06-18408-00-SP
County	CHAMPAIGN
Project	Pesotum Twp (Xing(#289 106W)

Made by J COOPER Date 7/18/2022 Checked by GDA Date 7/19/2022  
  
 Regional Engineer

Local Public Agency	County	Section Number	Route(s) (Street/Road Name)
Pesotum Township	Champaign	06-18408-00-SP	ICRR Crossing, 100N (TR 307)(

## CONTRACTOR CERTIFICATIONS

The certifications hereinafter made by the bidder are each a material representation of fact upon which reliance is placed should the Department enter into the contract with the bidder.

1. **Debt Delinquency.** The bidder or contractor or subcontractor, respectively, certifies that it is not delinquent in the payment of any tax administered by the Department of Revenue unless the individual or other entity is contesting, in accordance with the procedure established by the appropriate Revenue Act, its liability for the tax or the amount of the tax. Making a false statement voids the contract and allows the Department to recover all amounts paid to the individual or entity under the contract in a civil action.
2. **Bid-Rigging or Bid Rotating.** The bidder or contractor or subcontractor, respectively, certifies that it is not barred from contracting with the Department by reason of a violation of either 720 ILCS 5/33E-3 or 720 ILCS 5/33E-4.

A violation of section 33E-3 would be represented by a conviction of the crime of bid-rigging which, in addition to Class 3 felony sentencing, provides that any person convicted of this offense, or any similar offense of any state or the United States which contains the same elements as this offense shall be barred for 5 years from the date of conviction from contracting with any unit of State or local government. No corporation shall be barred from contracting with any unit of State or local government as a result of a conviction under this Section of any employee or agent of such corporation if the employee so convicted is no longer employed by the corporation: (1) it has been finally adjudicated not guilty or (2) if it demonstrates to the governmental entity with which it seeks to contract that entity finds that the commission of the offense was neither authorized, requested, commanded, nor performed by a director, officer or a high managerial agent on behalf of the corporation.

A violation of Section 33E-4 would be represented by a conviction of the crime of bid-rotating which, in addition to Class 2 felony sentencing, provides that any person convicted of this offense or any similar offense of any state or the United States which contains the same elements as this offense shall be permanently barred from contracting with any unit of State or Local government. No corporation shall be barred from contracting with any unit of State or Local government as a result of a conviction under this Section of any employee or agent of such corporation if the employee so convicted is no longer employed by the corporation and: (1) it has been finally adjudicated not guilty or (2) if it demonstrates to the governmental entity with which it seeks to contract and that entity finds that the commission of the offense was neither authorized, requested, commanded, nor performed by a director, officer or a high managerial agent on behalf of the corporation.

3. **Bribery.** The bidder or contractor or subcontractor, respectively, certifies that, it has not been convicted of bribery or attempting to bribe an officer or employee of the State of Illinois or any unit of local government, nor has the firm made an admission of guilt of such conduct which is a matter of record, nor has an official, agent, or employee of the firm committed bribery or attempted bribery on behalf of the firm and pursuant to the direction or authorization of a responsible official of the firm.
4. **Interim Suspension or Suspension.** The bidder or contractor or subcontractor, respectively, certifies that it is not currently under a suspension as defined in Subpart I of Title 44 Subtitle A Chapter III Part 6 of the Illinois Administrative code. Furthermore, if suspended prior to completion of this work, the contract or contracts executed for the completion of this work may be canceled.



Local Public Agency	County	Section Number	Route(s) (Street/Road Name)
Pesotum Township	Champaign	06-18408-00-SP	ICRR Crossing, 100N (TR 307)

### SIGNATURES

(If an individual)

Signature of Bidder		Date
Business Address		
City	State	Zip Code

(If a partnership)

Firm Name		
Signature		Date
Title		
Business Address		
City	State	Zip Code

Insert the Names and Addresses of all Partners

----------------------

(If a corporation)

Corporate Name		
Stark Excavating, Inc.		
Signature		Date
		3-2-2023
Title		
Vice President		
Business Address		
1805 W. Washington St.		
City	State	Zip Code
Bloomington	IL	61701

Insert Names of Officers

President
Dave K. Stark

Attest:

*Ila J. Slagell*

Secretary

Secretary

Ila J. Slagell

Treasurer

Gary W. Masso



Local Public Agency	County	Street Name/Road Name	Section Number
Pesotum Township	Champaign	TR 307 (100N)	06-18408-00-SP

All contractors are required to complete the following certification

- ☒ For this contract proposal or for all bidding groups in this deliver and install proposal.  
☐ For the following deliver and install bidding groups in this material proposal.

--

Illinois Department of Transportation policy, adopted in accordance with the provisions of the Illinois Highway Code, requires this contract to be awarded to the lowest responsive and responsible bidder. The award decision is subject to approval by the Department. In addition to all other responsibility factors, this contract or deliver and install proposal requires all bidders and all bidder's subcontractors to disclose participation in apprenticeship or training programs that are (1) approved by and registered with the United States Department of Labor's Bureau of Apprenticeship and Training, and (2) applicable to the work of the above indicated proposals or groups. Therefore, all bidders are required to complete the following certification:

1. Except as provided in paragraph 4 below, the undersigned bidder certifies that it is a participant, either as an individual or as part of a group program, in an approved apprenticeship or training program applicable to each type of work or craft that the bidder will perform with its own employees.
2. The undersigned bidder further certifies, for work to be performed by subcontract, that each of its subcontractors either (A) is, at the time of such bid, participating in an approved, applicable apprenticeship or training program; or (B) will, prior to commencement of performance of work pursuant to this contract, establish participation in an approved apprenticeship or training program applicable to the work of the subcontract.
3. The undersigned bidder, by inclusion in the list in the space below, certifies the official name of each program sponsor holding the Certificate of Registration for all of the types of work or crafts in which the bidder is a participant and that will be performed with the bidder's employees. Types of work or craft that will be subcontracted shall be included and listed as subcontract work. The list shall also indicate any type of work or craft job category for which there is no applicable apprenticeship or training program available.

SEE ATTACHED

4. Except for any work identified above, if any bidder or subcontractor shall perform all or part of the work of the contract or deliver and install proposal solely by individual owners, partners or members and not by employees to whom the payment of prevailing rates of wages would be required, check the following box, and identify the owner/operator workforces and positions of ownership. ☐

--

The requirements of this certification and disclosure are a material part of the contract, and the contractor shall require this certification provision to be included in all approved subcontracts. The bidder is responsible for making a complete report and shall make certain that each type of work or craft job category that will be utilized on the project is accounted for and listed. The Department at any time before or afterward may require the production of a copy of each applicable Certificate of Registration issued by the United States Department of Labor evidencing such participation by the contractor and any or all of its subcontractors. In order to fulfill the participation requirement, it shall not be necessary that any applicable program sponsor be currently taking or that it will take applications for apprenticeship, training or employment during the performance of the work of this contract or deliver and install proposal.

Bidder	Signature	Date	
Stark Excavating, Inc.		3/2/2023	
Title			
Vice President			
Address	City	State	Zip Code
1805 W. Washington St.	Bloomington	IL	61701





Local Public Agency	County	Street Name/Road Name	Section Number
Pesotum Township	Champaign	TR 307 (100N)	06-08408-00-SP

I, David K. Stark, Jr. of Bloomington, Illinois  
Name of Affiant City of Affiant State of Affiant

being first duly sworn upon oath, state as follows:

1. That I am the Vice President of Stark Excavating, Inc.  
Officer or Position Bidder
2. That I have personal knowledge of the facts herein stated.
3. That, if selected under the proposal described above, Stark Excavating, Inc., will maintain a business office in the  
Bidder  
 State of Illinois, which will be located in Champaign County, Illinois.  
County
4. That this business office will serve as the primary place of employment for any persons employed in the construction contemplated by this proposal.
5. That this Affidavit is given as a requirement of state law as provided in Section 30-22(8) of the Illinois Procurement Code.

Signature	Date
	3.2.2023
Print Name of Affiant	
David K. Stark, Jr.	

**Notary Public**

State of IL

County Woodford

Signed (or subscribed or attested) before me on March 2, 2023 by  
(date)

David K. Stark, Jr., authorized agent(s) of  
(name/s of person/s)

Stark Excavating, Inc.  
Bidder

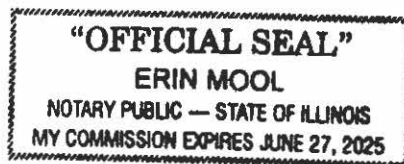

(SEAL)

Signature of Notary Public  
  
 My commission expires 6-27-2025



**Illinois Department  
of Transportation**

**Local Public Agency  
Proposal Bid Bond**



Local Public Agency	County	Section Number
Pesotum Township	Champaign	06-18408-00-SP

WE, Stark Excavating, Inc - 1805 W Washington St., Bloomington IL 61701 as PRINCIPAL, and Berkley Insurance Company - 475 Steamboat Rd., Greenwich CT 06830 as SURETY, are held jointly, severally and firmly bound unto the above Local Public Agency (hereafter referred to as "LPA") in the penal sum of 5% of the total bid price, or for the amount specified in the proposal documents in effect on the date of invitation for bids, whichever is the lesser sum. We bind ourselves, our heirs, executors, administrators, successors, and assigns, jointly pay to the LPA this sum under the conditions of this instrument.

WHEREAS THE CONDITION OF THE FOREGOING OBLIGATION IS SUCH that, the said PRINCIPAL is submitting a written proposal to the LPA acting through its awarding authority for the construction of the work designated as the above section.

THEREFORE if the proposal is accepted and a contract awarded to the PRINCIPAL by the LPA for the above designated section and the PRINCIPAL shall within fifteen (15) days after award enter into a formal contract, furnish surety guaranteeing the faithful performance of the work, and furnish evidence of the required insurance coverage, all as provided in the "Standard Specifications for Road and Bridge Construction" and applicable Supplemental Specifications, then this obligation shall become void, otherwise it shall remain in full force and effect.

IN THE EVENT the LPA determines the PRINCIPAL has failed to enter into a formal contract in compliance with any requirements set forth in the preceding paragraph, then the LPA acting through its awarding authority shall immediately be entitled to recover the full penal sum set out above, together with all court costs, all attorney fees, and any other expense of recovery.

IN TESTIMONY WHEREOF, the said PRINCIPAL and the said SURETY have caused this instrument to be signed by their respective officers this 2nd of March, 2023  
Day Month and Year

**Principal**

Company Name

Stark Excavating, Inc

Signature

Date

By:

*(Signature)*  
(David K. Stark, Jr)

03/02/2023

Title

Vice President

Company Name

N/A

Signature

Date

By:

N/A

N/A

Title

N/A

(If Principal is a joint venture of two or more contractors, the company names, and authorized signatures of each contractor must be affixed.)

**Surety**

Name of Surety

Berkley Insurance Company

Signature of Attorney-in-Fact

Date

By:

*(Signature)*  
(Lucas Sherman)

03/02/2023

STATE OF IL  
COUNTY OF DOUGLAS

I Kyrsten N. Cox, a Notary Public in and for said county do hereby certify that

David K. Stark, Jr and Lucas Sherman

(Insert names of individuals signing on behalf of PRINCIPAL & SURETY)

who are each personally known to me to be the same persons whose names are subscribed to the foregoing instrument on behalf of PRINCIPAL and SURETY, appeared before me this day in person and acknowledged respectively, that they signed and delivered said instruments as their free and voluntary act for the uses and purposes therein set forth.

Given under my hand and notarial seal this 2nd day of March, 2023  
Day Month and Year



Notary Public Signature

*(Signature)*

Date commission expires 09/07/2023

Local Public Agency

County

Section Number

Pesotum Township

Champaign

06-18408-00-SP

## ELECTRONIC BID BOND

☐ **Electronic bid bond is allowed (box must be checked by LPA if electronic bid bond is allowed)**

The Principal may submit an electronic bid bond, in lieu of completing the above section of the Proposal Bid Bond Form. By providing an electronic bid bond ID code and signing below, the Principal is ensuring the identified electronic bid bond has been executed and the Principal and Surety are firmly bound unto the LPA under the conditions of the bid bond as shown above. (If PRINCIPAL is a joint venture of two or more contractors, an electronic bid bond ID code, company/Bidder name title and date must be affixed for each contractor in the venture.)

Electronic Bid Bond ID Code

--	--	--	--	--	--	--	--	--	--	--	--	--	--	--	--	--	--	--	--

Company/Bidder Name

--

Signature

--

Date

--

Title

--



POWER OF ATTORNEY  
BERKLEY INSURANCE COMPANY  
WILMINGTON, DELAWARE

NOTICE: The warning found elsewhere in this Power of Attorney affects the validity thereof. Please review carefully.

KNOW ALL MEN BY THESE PRESENTS, that BERKLEY INSURANCE COMPANY (the "Company"), a corporation duly organized and existing under the laws of the State of Delaware, having its principal office in Greenwich, CT, has made, constituted and appointed, and does by these presents make, constitute and appoint: *Lucas Sherman of CoraMae, Inc. dba Insurance Risk Managers of Champaign, IL* its true and lawful Attorney-in-Fact, to sign its name as surety only as delineated below and to execute, seal, acknowledge and deliver any and all bonds and undertakings, with the exception of Financial Guaranty Insurance, providing that no single obligation shall exceed Fifty Million and 00/100 U.S. Dollars (U.S.\$50,000,000.00), to the same extent as if such bonds had been duly executed and acknowledged by the regularly elected officers of the Company at its principal office in their own proper persons.

This Power of Attorney shall be construed and enforced in accordance with, and governed by, the laws of the State of Delaware, without giving effect to the principles of conflicts of laws thereof. This Power of Attorney is granted pursuant to the following resolutions which were duly and validly adopted at a meeting of the Board of Directors of the Company held on January 25, 2010:

**RESOLVED**, that, with respect to the Surety business written by Berkley Surety, the Chairman of the Board, Chief Executive Officer, President or any Vice President of the Company, in conjunction with the Secretary or any Assistant Secretary are hereby authorized to execute powers of attorney authorizing and qualifying the attorney-in-fact named therein to execute bonds, undertakings, recognizances, or other suretyship obligations on behalf of the Company, and to affix the corporate seal of the Company to powers of attorney executed pursuant hereto; and said officers may remove any such attorney-in-fact and revoke any power of attorney previously granted; and further

**RESOLVED**, that such power of attorney limits the acts of those named therein to the bonds, undertakings, recognizances, or other suretyship obligations specifically named therein, and they have no authority to bind the Company except in the manner and to the extent therein stated; and further

**RESOLVED**, that such power of attorney revokes all previous powers issued on behalf of the attorney-in-fact named; and further

**RESOLVED**, that the signature of any authorized officer and the seal of the Company may be affixed by facsimile to any power of attorney or certification thereof authorizing the execution and delivery of any bond, undertaking, recognizance, or other suretyship obligation of the Company; and such signature and seal when so used shall have the same force and effect as though manually affixed. The Company may continue to use for the purposes herein stated the facsimile signature of any person or persons who shall have been such officer or officers of the Company, notwithstanding the fact that they may have ceased to be such at the time when such instruments shall be issued.

IN WITNESS WHEREOF, the Company has caused these presents to be signed and attested by its appropriate officers and its corporate seal hereunto affixed this 3<sup>rd</sup> day of December, 2019.

Attest:

(Seal)

By

Ira S. Lederman  
Executive Vice President & Secretary

Berkley Insurance Company

By

Jeffrey M. Hafter  
Senior Vice President

**WARNING: THIS POWER INVALID IF NOT PRINTED ON BLUE "BERKLEY" SECURITY PAPER.**

STATE OF CONNECTICUT )

) ss:

COUNTY OF FAIRFIELD )

Sworn to before me, a Notary Public in the State of Connecticut, this 3<sup>rd</sup> day of December, 2019, by Ira S. Lederman and Jeffrey M. Hafter who are sworn to me to be the Executive Vice President and Secretary, and the Senior Vice President, respectively, of Berkley Insurance Company.

MARIA C RUNDRAKEN  
NOTARY PUBLIC  
CONNECTICUT  
MY COMMISSION EXPIRES  
APRIL 30, 2024

Maria C. Rundraken  
Notary Public, State of Connecticut

**CERTIFICATE**

I, the undersigned, Assistant Secretary of BERKLEY INSURANCE COMPANY, DO HEREBY CERTIFY that the foregoing is a true, correct and complete copy of the original Power of Attorney; that said Power of Attorney has not been revoked or rescinded and that the authority of the Attorney-in-Fact set forth therein, who executed the bond or undertaking to which this Power of Attorney is attached, is in full force and effect as of this date.

Given under my hand and seal of the Company, this 2nd day of March, 2023

(Seal)

Vincent P. Forte  
Vincent P. Forte

WARNING - Any unauthorized reproduction or alteration of this document is prohibited. This power of attorney is void unless seals are readable and the certification seal at the bottom is embossed. The background imprint, warning and verification instructions (on reverse) must be in blue ink.



## **CHAMPAIGN County**

### **K. Apprenticeship & Training Certification**

1. Operators:  
Operating Engineers Local 841
2. Laborers:  
International Laborers Local 703
3. Teamster:  
Teamsters Local No. 26
4. Carpenters:  
Carpenters Local Union No. 44
5. Steel Work:  
International Ass'n of Bridge, Structural, Ornamental & Reinforcement  
Ironworker, Local 380
6. Finishers:  
Operative Plasterers & Cement Mason Local 143



**Illinois Department  
of Transportation**

## Certificate of Eligibility

Contractor No 5672

Stark Excavating, Inc.  
1805 W. Washington Street Bloomington, IL 61701-3703

WHO HAS FILED WITH THE DEPARTMENT AN APPLICATION FOR PREQUALIFICATION STATEMENT OF EXPERIENCE, EQUIPMENT AND FINANCIAL CONDITION IS HEREBY QUALIFIED TO BID AT ANY OF DEPARTMENT OF TRANSPORTATION LETTINGS IN THE CLASSES OF WORK AND WITHIN THE AMOUNT AND OTHER LIMITATIONS OF EACH CLASSIFICATION, AS LISTED BELOW, FOR SUCH PERIOD AS THE UNCOMPLETED WORK FROM ALL SOURCES DOES NOT EXCEED

SUPER UNLIMITED

001	EARTHWORK	\$17,425,000
002	PCC PAVING	\$16,200,000
012	DRAINAGE	\$24,350,000
017	CONCRETE CONSTRUCTION	\$15,500,000
034	DEMOLITION	\$6,575,000
08A	AGGREGATE BASES & SURF. (A)	\$8,550,000
09B	HIGHWAY & RAILROAD STRUCT	\$28,475,000

THIS CERTIFICATE OF ELIGIBILITY IS VALID FROM 8/18/2022 TO 4/30/2023 INCLUSIVE, AND SUPERSEDES ANY CERTIFICATE PREVIOUSLY ISSUED, BUT IS SUBJECT TO REVISION OR REVOCATION, IF AND WHEN CHANGES IN THE FINANCIAL CONDITION OF THE CONTRACTING FIRM OR OTHER FACTS JUSTIFY SUCH REVISIONS OR REVOCATION. ISSUED AT SPRINGFIELD, ILLINOIS ON 8/18/2022.

Engineer of Construction





## Evidence of Authority to Sign

"I, David K. Stark, certify that I am the President of Stark Excavating, Inc. named as Contractor hereinabove; that David K. Stark, Jr., who signed the foregoing Agreement on behalf of the Contractor was then Vice President of said Corporation; the said Agreement was duly signed for and in behalf of said Corporation by authority of its governing body, and is within the scope of its corporate powers."

\_\_\_\_\_  
President

\_\_\_\_\_  
Secretary

**Champaign County**  
**Section 06-18408-00-SP**  
**TR 307 (100N)**  
**Pesotum Township**

## **INDEX TO SPECIAL PROVISIONS**

**Description of Work**

**Prequalification of Bidders**

**Precaution for Utilities**

**Traffic Control and Protection Plans**

**Furnished Excavation**

**Bituminous Cover and Seal Coats**

**Subbase Granular Embankment, Special**

**Railroad Flaggers**

**Railroad Protective Liability Insurance**



Local Public Agency	County	Section Number
Pesotum Township	Champaign	06-18408-00-SP

The following Special Provision supplement the "Standard Specifications for Road and Bridge Construction", adopted

January 1, 2022

, the latest edition of the "Manual on Uniform Traffic Control Devices for Streets and Highways", and the "Manual of Test Procedures of Materials" in effect on the date of invitation of bids, and the Supplemental Specification and Recurring Special Provisions indicated on the Check Sheet included here in which apply to and govern the construction of the above named section, and in case of conflict with any parts, or parts of said Specifications, the said Special Provisions shall take precedence and shall govern.

#### DESCRIPTION OF WORK

This work shall consist of the construction of a revised at-grade railroad crossing with the existing ICGR on TR 307 (100N). This crossing has received automatic flashing light signals and gates as part of the Grade Crossing Protection Fund. This installation was constructed by others. The new grade crossing approaches shall adhere to Section 1535.204, Grade Line of Highway Approaches, of Part 1535, Crossings of Rail Carriers and Highways. Unless otherwise specified, the proposed grade line shall be reconstructed as specified in that Section. The work shall include the placement of an aggregate base course that will be seal coated once the aggregate is graded and compacted to the required specifications.

#### PREQUALIFICATION OF BIDDERS

Provisions of Check Sheet LRS #6 of the Standard Specifications shall apply to this project. Prequalification will be required.

#### PRECAUTION FOR UTILITIES

The Contractor shall take whatever precautions which may be necessary to protect the property of the various public utilities which may be located underground or above ground, at or adjacent to the site of this improvement.

#### TRAFFIC CONTROL PLANS

Description:

Traffic Control shall be in accordance with the applicable sections of the Standard Specifications for Road and Bridge Construction, the applicable guidelines contained in the Illinois Manual on Uniform Traffic Control Devices for Streets and Highways, these special provisions, and any special details and Highway Standards contained herein and in the plans.

Traffic:

The road shall be closed to all thru traffic. Local residents will be allowed access in accordance with Article 107.09 of the Standard Specifications.

As clarification of Article 107.14; Traffic control consisting of flagmen, barricades, signs and lights



confirming to the Standards, Specifications and Uniform Manual on Traffic Control Devices shall be furnished in the event the closed portion is open to traffic.

Special attention is called to Article 107.09 and 107.14 of the Standard Specifications for Roads and Bridge Construction and the following (1) Highway Standards and (2) other special provisions.

(1) Traffic Control and Protection Incidental to the Contract: Traffic control and protection required under the following standards will be considered incidental to construction and will not be measured for payment.

Standard BLR 21-9

Standard 701901-4

(2) Type III barricades, to be erected by the Contractor, shall extend from shoulder break to shoulder break, Standard 701901 at each end of the construction limits or as directed by the Engineer at each end of the closed area. Two flashing lights shall be provided for each barricade located on the paved surface. Flashing lights shall be provided on both advance warning lights.

#### FURNISHED EXCAVATION:

This work shall consist of the placement and compaction of suitable materials within the limits of the Contract. The material and all appurtenant actions required to meet the required results shall conform to the applicable portions of Section 204 of the Standard Specifications.

#### BITUMINOUS MATERIALS (COVER AND SEAL COATS):

This work shall consist of a multiple course bituminous surface treatment whose application shall be in accordance to the applicable portions of Section 406 of the Standard Specifications.

#### Basis of Payment:

Payment for BITUMINOUS MATERIALS (COVER AND SEAL COATS) , measured as specified, will be made at the Contract unit price per ton, which payment shall constitute full compensation for furnishing, transporting, and placing the material as specified.

#### SUBBASE GRANULAR EMBANKMENT, SPECIAL:

##### Description:

This work shall consist of the furnishing, placement and compaction of a layer of granular embankment material on the finished subgrade to the lines, dimensions, and cross sections shown on the Plans, and in accordance with this special provision.

##### Materials:

The materials used for SUBGRADE GRANULAR EMBANKMENT, SPECIAL shall be gravel, crushed gravel, or pit/bank run gravel or gravely sand capable of developing a compacted maximum dry density, as

Local Public Agency	County	Section Number
Pesotum Township	Champaign	06-18408-00-SP

determined by methods outlined below, of not less than 105 pounds per cubic foot. Not more than 16 percent or less than 4 percent of the materials shall pass a No. 200 sieve determined in accordance with AASHTO T-11; and the plasticity index of the material passing a No. 40 sieve determined in accordance with AASHTO T 90 shall not exceed 6, unless the use of other materials is authorized in writing by the Engineer. The material shall not contain aggregate particles larger than 3 inches, nor an excessive amount

of soft or friable particles with mineral aggregates, as determined in accordance with AASHTO T-112, which may readily break down into fine material. The combined content of such soft particles with mineral aggregate plus the content of material passing the No. 200 sieve by the wet sieving process shall not exceed 20 percent of the total sample.

If materials meeting the foregoing requirements cannot be obtained from excavations of existing granular subbase aggregate within the project limits or from borrow areas developed by the Contractor, the material shall be obtained from other sources selected by the Contractor and approved by the Engineer, at no additional cost.

The use of air-cooled blast furnace slag or steel slag will not be allowed. No reinforcement, subgrade soils, or organic material shall be present.

#### General Requirements:

Any existing subbase aggregate that is to be reused as Subgrade Granular Embankment, Special shall be excavated and stockpiled in accordance with this Special Provision or windrowed after which the subgrade shall be prepared in accordance with Section 301 of the Standard Specifications. Prior to final approval for placing of the Subgrade Granular Embankment, Special, the subgrade shall be prepared and checked for specified density in accordance with Article 301.04 of the Standard Specifications. Placing of loose material on the finished subgrade shall not proceed until the subgrade has been approved by the Engineer for a distance of not less than 500 feet in advance of the laying of the granular embankment, special material. No material shall be placed upon overly moist, muddy or otherwise unstable subgrade or on material containing frost at any depth. Should the subgrade be dry to the point of being dusty, it shall be moistened by sprinkling as may be directed by the Engineer.

After the granular embankment, special material has been spread uniformly on the prepared subgrade, any portion of the layer in which segregation has occurred shall be removed and replaced with satisfactory material, or shall be remixed as directed by the Engineer.

If the material is too dry, it shall be uniformly moistened by sprinkling and by manipulating the material in a manner approved by the Engineer, such that the moisture will be evenly distributed throughout the depth of the material. If the material is too moist, it shall be allowed to dry and, if necessary to achieve uniform distribution of moisture throughout its depth, it shall be manipulated in a manner approved by the Engineer. The granular embankment, special shall be constructed in layers, each having a compacted thickness not to exceed six (6) inches; except that the Contractor may construct the granular embankment, special in one layer by using vibratory equipment for compacting, providing he can show to the satisfaction of the Engineer that he is able to obtain the required density.

During preparation, construction, and after completion of the Subgrade Granular Embankment, Special, adequate drainage shall be provided at all times to prevent water from standing on the granular embankment, special surface. The granular embankment, special shall be so constructed that it will have, as nearly as possible, uniform density throughout.

The finished surface of the granular embankment, special shall not vary more than one-tenth (0.1) foot

Local Public Agency	County	Section Number
Pesotum Township	Champaign	06-18408-00-SP

below the elevation shown on the Plans. No tolerance above the Plan elevations will be allowed. Any deviation in excess of this amount shall be corrected by loosening, adding or removing materials, reshaping and re-compacting or sprinkling and rolling, all at the Contractor's expense.

No hauling shall be done nor equipment moved over the granular embankment, special when its condition is such that undue distortion will result. If these conditions prevail, the granular embankment, special shall be protected with adequate plank runways, mats, or other satisfactory means, if hauling is done thereon.

#### Compaction:

The granular embankment, special shall be compacted to 95 percent of the maximum dry density as

determined by AASHTO T 99, Method C. The granular embankment, special thus compacted shall cover the full width of the section as shown on the Plans. Additional water shall be added when needed during compaction operations to obtain the specified density and optimum moisture content.

Compaction of the granular embankment, special shall be obtained using equipment conforming to the requirements of Section 1101 or by other equipment approved by the Engineer.

Compacting shall start at the edges and progress towards the center, and shall continue until the required density as herein specified is obtained. When the proper cross-section has been obtained and compaction is completed, the surface shall be rolled with a flatwheel roller to seal the surface.

#### Method of Measurement:

Aggregate used for SUBGRADE GRANULAR EMBANKMENT, SPECIAL will be measured for payment in Tons.

Water required to be added for compaction of the grade will not be measured for payment, but shall be considered as included in the cost of the item of work being constructed.

#### Basis of Payment:

Payment for SUBGRADE GRANULAR EMBANKMENT, SPECIAL, measured as specified, will be made at the Contract unit price per ton, which payment shall constitute full compensation for furnishing, transporting, and placing the material as specified.

#### RAILROAD FLAGGERS

Contractors who perform any work on railroad-owned property are required to have a Railroad Flagger available before and during all operations that are within 50-feet of the railroad tracks or facilities.

#### Basis of Payment:

All work requiring the use of a railroad flagger will be paid as force account work based on guidelines included in Sec. 109.04 of the Standard Specifications for Road and Bridge Construction.

Local Public Agency

County

Section Number

Pesotum Township

Champaign

06-18408-00-SP

#### RAILROAD PROTECTIVE LIABILITY INSURANCE

Contractors who perform work within 50-feet of any railroad-owned property are required to have Railroad Protective Liability insurance. The coverage is project specific and covers bodily injury and property damage arising from acts or omissions relating to job-site operations being performed by the designated contractor.

#### Basis of Payment:

Payment for Railroad Protective Liability Insurance, will be paid at the Contract unit price Lump Sum, for which payment shall constitute full compensation for the coverage required.





## Special Waste Screening For Local Agency Projects



Route	Date	Section
TR 307 (100N)	07/29/22	06-18408-00-SP
Completed By	County	LA/Company
John Cooper, Asst Co Engineer	Champaign	Champaign County
Local Agency		
Pesotum Township Rd Dist		

### Level 1 Screening Criteria

Will project involve?

- Acquisition of additional right-of-way (ROW) or easements? (temporary or permanent?)
- Railroad right-of-way (other than a single rail rural ROW with no maintenance facilities)
- Excavation or subsurface utility relocation  
(see BLRS Manual Chapter 20 for definition of "excavation")

Yes No Don't Know

<input type="checkbox"/>	<input checked="" type="checkbox"/>	<input type="checkbox"/>
<input checked="" type="checkbox"/>	<input type="checkbox"/>	<input type="checkbox"/>
<input type="checkbox"/>	<input checked="" type="checkbox"/>	<input type="checkbox"/>

If all responses are "No," the project has cleared Level 1 special waste screening; no further action is required except to complete the bottom of this page by indicating a PESA is not required. If any response is "Yes" or "Don't Know," continue to Level 2 Screening Criteria.

### Level 2 Screening Criteria

Does the project involve any of the following environmental conditions within the corresponding minimum search distance?

Environmental Conditions	Minimum Search Distance	Database Search		Reconnaissance Site	
		Yes	No	Yes	No
Industrial and/or commercial property	0.25 Mile			<input type="checkbox"/>	<input checked="" type="checkbox"/>
Other Environmental Conditions* (please see detail below)	Property and Adjoining Property			<input type="checkbox"/>	<input checked="" type="checkbox"/>
State UST <a href="http://webapps.sfm.illinois.gov/ustsearch/">http://webapps.sfm.illinois.gov/ustsearch/</a>	Property and Adjoining Property	<input type="checkbox"/>	<input checked="" type="checkbox"/>		
State LUST <a href="https://www2.illinois.gov/epa/topics/cleanup-programs/bol-database/Pages/leaking-ust.aspx">https://www2.illinois.gov/epa/topics/cleanup-programs/bol-database/Pages/leaking-ust.aspx</a>	0.50 Mile	<input type="checkbox"/>	<input checked="" type="checkbox"/>		
State Voluntary Cleanup, Brownfield, or Landfills <a href="https://www2.illinois.gov/epa/topics/cleanup-programs/bol-database/Pages/srp.aspx">https://www2.illinois.gov/epa/topics/cleanup-programs/bol-database/Pages/srp.aspx</a>	0.50 Mile	<input type="checkbox"/>	<input checked="" type="checkbox"/>		
Federal NPL: NPL delisted, CERCLIS; CERCLIS NFRAP <a href="https://cumulis.epa.gov/supercpad/CurSites/srchsites.cfm">https://cumulis.epa.gov/supercpad/CurSites/srchsites.cfm</a>	1.0 Mile, 0.5 Mile, 0.5 Mile, 0.5 Mile, respectively	<input type="checkbox"/>	<input checked="" type="checkbox"/>		
Federal RCRA CORRACTS facilities; RCRA non-CORRACTS TSD facilities <a href="http://www.epa.gov/enviro/facts/rcrainfo/search.html">http://www.epa.gov/enviro/facts/rcrainfo/search.html</a>	1.0 Mile, 0.5 Mile, respectively	<input type="checkbox"/>	<input checked="" type="checkbox"/>		
Federal RCRA generators list <a href="http://www.epa.gov/enviro/facts/rcrainfo/search.html">http://www.epa.gov/enviro/facts/rcrainfo/search.html</a>	Property and Adjoining Property	<input type="checkbox"/>	<input checked="" type="checkbox"/>		
Federal RCRA Brownfield sites <a href="https://ofmpub.epa.gov/apex/cimc/f?p=CIMC:68.:0">https://ofmpub.epa.gov/apex/cimc/f?p=CIMC:68.:0</a>	0.50 Mile	<input type="checkbox"/>	<input checked="" type="checkbox"/>		
Federal ERNS System <a href="http://www.nrc.uscg.mil/">http://www.nrc.uscg.mil/</a>	Property	<input type="checkbox"/>	<input checked="" type="checkbox"/>		

\*Other environmental conditions are identified through site reconnaissance and include situations that may negatively affect the property including the presence of, for example, illegal dumping, waste associated with "crack" or methamphetamine houses (i.e., discarded hazardous material on the outside of a property, battery piles, paint spills, abandoned transformers, surface staining, vegetative damage, etc.)

NOTE: If all responses to Level 2 criteria are "No" then a PESA is not required.

Is a Preliminary Environmental Site Assessment (PESA) required? ☐ Yes ☒ No

PESA not required based on Level 1 or Level 2 Screening: Level 1 \_\_\_\_\_ Level 2 X



Route TR307 (100N)	Section Number 06-18408-00-SP	County Champaign	Local Agency Pesotum Township Rd Dist
Date 07/29/22	Completed By John Cooper, Asst. Co Engineer	LA/Company Champaign County	

**Screening Applicability**

Projects required Department review for cultural and biological resources if any of the following criteria are met:

**Yes      No**

Involve acquisition of new right-of-way or easements? (temporary or permanent), or construction activities outside the existing right-of-way?

☐      ☒

Require a drainage structure runaround or any in-stream work (the installation of riprap on a stream bank is considered in-stream work)?

☐      ☒

Potentially affect a recognized Illinois Natural Areas Inventory site or Illinois Dedicated Nature Preserve, a wetland, or a location where a State or Federal listed species is known to occur.

☐      ☒

To screen projects, visit <http://dnr.illinois.gov/EcoPublic>. Scroll to bottom of screen and click "Next," then Question 1, select **"To obtain information on Illinois T&E species or INAI sites for project planning purposes."**

For wetlands screening, visit <http://www.fws.gov/wetlands/DataMapper.html>

Involves or have the potential to affect a historic property (site, buildings, structure, object, or district) listed on, eligible for listing on, or potentially eligible for listing on the National Register of Historic Places (NRHP) including all National Historic Landmarks.

☐      ☒

Visit <https://www2.illinois.gov/dnrhistoric/Research/Pages/OnlineResources.aspx>

Involves replacement or rehabilitation of a bridge 40 years old or older?

☐      ☒

Involve a bridge or culvert currently listed in IDOT's Historic Bridge List (HBL) (Note: that the HBL is out of date, and a bridge that is not on the HBL may be eligible for listing on the NRHP)

☐      ☒

If a project does not require additional right-of-way, but does require cultural or biological resource coordination (e.g., a project is located within/adjoining a historic property or in-stream work), an ESR needs to be submitted in the District.

☐      ☒

If there will be a new road, bike trail, or sidewalk on a new alignment regardless of who owns right-of-way

☐      ☒

**Projects require Department review for special waste if any of the following criteria are met:**

- project plans are prepared by IDOT for a LPA;
- project or portion of a project affecting State right-of-way or a road under State jurisdiction;
- project crosses or involves railroad right-of-way (other than single rail rural right-of-way with no maintenance facilities) on a State-maintained Route;
- project involves any excavation or subsurface utility relocation on State right-of-way;
- project acquiring right-of-way in the name of the State; or
- project involving temporary or permanent easements in the name of the State.

☐      ☒  
☐      ☒  
☐      ☒  
☐      ☒  
☐      ☒  
☐      ☒

If all responses are "no," then an ESR is not required. If a single answer is "yes," an ESR is required and the District Environmental Coordinator shall be contacted.

For additional information, see Chapters 10 & 20 in the Bureau of Local Roads Manual. See next page for ESR supporting documentation.

INDEX  
FOR  
SUPPLEMENTAL SPECIFICATIONS  
AND RECURRING SPECIAL PROVISIONS

Adopted January 1, 2023

This index contains a listing of SUPPLEMENTAL SPECIFICATIONS and frequently used RECURRING SPECIAL PROVISIONS.

ERRATA    Standard Specifications for Road and Bridge Construction

(Adopted 1-1-22) (Revised 1-1-23)

SUPPLEMENTAL SPECIFICATIONS

<u>Std. Spec. Sec.</u>	<u>Page No.</u>
202    Earth and Rock Excavation .....	1
204    Borrow and Furnished Excavation .....	2
207    Porous Granular Embankment .....	3
211    Topsoil and Compost .....	4
407    Hot-Mix Asphalt Pavement (Full-Depth) .....	5
420    Portland Cement Concrete Pavement .....	6
502    Excavation for Structures .....	7
509    Metal Railings .....	8
540    Box Culverts .....	9
542    Pipe Culverts .....	29
586    Granular Backfill for Structures .....	34
644    High Tension Cable Median Barrier .....	35
782    Reflectors .....	36
801    Electrical Requirements .....	38
821    Roadway Luminaires .....	40
1003    Fine Aggregates .....	41
1004    Coarse Aggregates .....	42
1020    Portland Cement Concrete .....	43
1030    Hot-Mix Asphalt .....	44
1067    Luminaire .....	45
1097    Reflectors .....	52

## RECURRING SPECIAL PROVISIONS

The following RECURRING SPECIAL PROVISIONS indicated by an "X" are applicable to this contract and are included by reference:

<u>CHECK SHEET #</u>		<u>PAGE NO.</u>
1	Additional State Requirements for Federal-Aid Construction Contracts .....	53
2	Subletting of Contracts (Federal-Aid Contracts) .....	56
3	EEO .....	57
4	Specific EEO Responsibilities Non Federal-Aid Contracts .....	67
5	Required Provisions - State Contracts .....	72
6	Asbestos Bearing Pad Removal .....	78
7	Asbestos Waterproofing Membrane and Asbestos HMA Surface Removal .....	79
8	Temporary Stream Crossings and In-Stream Work Pads .....	80
9	Construction Layout Stakes .....	81
10	Use of Geotextile Fabric for Railroad Crossing .....	84
11	Subsealing of Concrete Pavements .....	86
12	Hot-Mix Asphalt Surface Correction .....	90
13	Pavement and Shoulder Resurfacing .....	92
14	Patching with Hot-Mix Asphalt Overlay Removal .....	93
15	Polymer Concrete .....	95
16	Reserved .....	97
17	Bicycle Racks .....	98
18	Temporary Portable Bridge Traffic Signals .....	100
19	Nighttime Inspection of Roadway Lighting .....	102
20	English Substitution of Metric Bolts .....	103
21	Calcium Chloride Accelerator for Portland Cement Concrete .....	104
22	Quality Control of Concrete Mixtures at the Plant .....	105
23	Quality Control/Quality Assurance of Concrete Mixtures .....	113
24	Reserved .....	129
25	Reserved .....	130
26	Temporary Raised Pavement Markers .....	131
27	Restoring Bridge Approach Pavements Using High-Density Foam .....	132
28	Portland Cement Concrete Inlay or Overlay .....	135
29	Portland Cement Concrete Partial Depth Hot-Mix Asphalt Patching .....	139
30	Longitudinal Joint and Crack Patching .....	142
31	Concrete Mix Design – Department Provided .....	144
32	Station Numbers in Pavements or Overlays .....	145



LOCAL ROADS AND STREETS RECURRING SPECIAL PROVISIONS

Table of Contents

<u>CHECK SHEET #</u>		<u>PAGE NO.</u>
LRS1	Reserved .....	147
LRS2	Furnished Excavation .....	148
LRS3	Work Zone Traffic Control Surveillance .....	149
LRS4	Flaggers in Work Zones .....	150
LRS5	Contract Claims .....	151
LRS6	Bidding Requirements and Conditions for Contract Proposals .....	152
LRS7	Bidding Requirements and Conditions for Material Proposals .....	158
LRS8	Reserved .....	164
LRS9	Bituminous Surface Treatments .....	165
LRS10	Reserved .....	169
LRS11	Employment Practices .....	170
LRS12	Wages of Employees on Public Works .....	172
LRS13	Selection of Labor .....	174
LRS14	Paving Brick and Concrete Paver Pavements and Sidewalks .....	175
LRS15	Partial Payments .....	178
LRS16	Protests on Local Lettings .....	179
LRS17	Substance Abuse Prevention Program .....	180
LRS18	Multigrade Cold Mix Asphalt .....	181
LRS19	Reflective Crack Control Treatment .....	182



## Check Sheet for Recurring Special Provisions

Local Public Agency	County	Section Number
PESOTUM TOWNSHIP ROAD DISTRICT	Champaign	06-18408-00-SP

☐ Check this box for lettings prior to 01/01/2023.

The Following Recurring Special Provisions Indicated By An "X" Are Applicable To This Contract And Are Included By Reference:

### Recurring Special Provisions

<u>Check Sheet #</u>		<u>Page No.</u>
1	<input type="checkbox"/> Additional State Requirements for Federal-Aid Construction Contracts	53
2	<input type="checkbox"/> Subletting of Contracts (Federal-Aid Contracts)	56
3	<input type="checkbox"/> EEO	57
4	<input type="checkbox"/> Specific EEO Responsibilities Non Federal-Aid Contracts	67
5	<input type="checkbox"/> Required Provisions - State Contracts	72
6	<input type="checkbox"/> Asbestos Bearing Pad Removal	78
7	<input type="checkbox"/> Asbestos Waterproofing Membrane and Asbestos HMA Surface Removal	79
8	<input type="checkbox"/> Temporary Stream Crossings and In-Stream Work Pads	80
9	<input type="checkbox"/> Construction Layout Stakes	81
10	<input type="checkbox"/> Use of Geotextile Fabric for Railroad Crossing	84
11	<input type="checkbox"/> Subsealing of Concrete Pavements	86
12	<input type="checkbox"/> Hot-Mix Asphalt Surface Correction	90
13	<input type="checkbox"/> Pavement and Shoulder Resurfacing	92
14	<input type="checkbox"/> Patching with Hot-Mix Asphalt Overlay Removal	93
15	<input type="checkbox"/> Polymer Concrete	95
16	<input type="checkbox"/> Reserved	97
17	<input type="checkbox"/> Bicycle Racks	98
18	<input type="checkbox"/> Temporary Portable Bridge Traffic Signals	100
19	<input type="checkbox"/> Nighttime Inspection of Roadway Lighting	102
20	<input type="checkbox"/> English Substitution of Metric Bolts	103
21	<input type="checkbox"/> Calcium Chloride Accelerator for Portland Cement Concrete	104
22	<input type="checkbox"/> Quality Control of Concrete Mixtures at the Plant	105
23	<input type="checkbox"/> Quality Control/Quality Assurance of Concrete Mixtures	113
24	<input type="checkbox"/> Reserved	129
25	<input type="checkbox"/> Reserved	130
26	<input type="checkbox"/> Temporary Raised Pavement Markers	131
27	<input type="checkbox"/> Restoring Bridge Approach Pavements Using High-Density Foam	132
28	<input type="checkbox"/> Portland Cement Concrete Inlay or Overlay	135
29	<input type="checkbox"/> Portland Cement Concrete Partial Depth Hot-Mix Asphalt Patching	139
30	<input type="checkbox"/> Longitudinal Joint and Crack Patching	142
31	<input type="checkbox"/> Concrete Mix Design - Department Provided	144
32	<input type="checkbox"/> Station Numbers in Pavements or Overlays	145

Local Public Agency

PESOTUM TOWNSHIP ROAD DISTRICT

County

Champaign

Section Number

06-18408-00-SP

The Following Local Roads And Streets Recurring Special Provisions Indicated By An "X" Are Applicable To This Contract And Are Included By Reference:

Local Roads And Streets Recurring Special Provisions

<u>Check Sheet #</u>			<u>Page No.</u>
LRS 1		<b>Reserved</b>	147
LRS 2	<input checked="" type="checkbox"/>	Furnished Excavation	148
LRS 3	<input checked="" type="checkbox"/>	Work Zone Traffic Control Surveillance	149
LRS 4	<input checked="" type="checkbox"/>	Flaggers in Work Zones	150
LRS 5	<input checked="" type="checkbox"/>	Contract Claims	151
LRS 6	<input checked="" type="checkbox"/>	Bidding Requirements and Conditions for Contract Proposals	152
LRS 7	<input type="checkbox"/>	Bidding Requirements and Conditions for Material Proposals	158
LRS 8		<b>Reserved</b>	164
LRS 9	<input checked="" type="checkbox"/>	Bituminous Surface Treatments	165
LRS 10		<b>Reserved</b>	169
LRS 11	<input checked="" type="checkbox"/>	Employment Practices	170
LRS 12	<input checked="" type="checkbox"/>	Wages of Employees on Public Works	172
LRS 13	<input checked="" type="checkbox"/>	Selection of Labor	174
LRS 14	<input type="checkbox"/>	Paving Brick and Concrete Paver Pavements and Sidewalks	175
LRS 15	<input checked="" type="checkbox"/>	Partial Payments	178
LRS 16	<input type="checkbox"/>	Protests on Local Lettings	179
LRS 17	<input type="checkbox"/>	Substance Abuse Prevention Program	180
LRS 18	<input type="checkbox"/>	Multigrade Cold Mix Asphalt	181
LRS 19	<input type="checkbox"/>	Reflective Crack Control Treatment	182

State of Illinois  
Department of Transportation  
Bureau of Local Roads and Streets

SPECIAL PROVISION  
FOR  
RAILROAD PROTECTIVE LIABILITY INSURANCE FOR LOCAL LETTINGS

Effective: March 1, 2005  
Revised: January 1, 2006

All references to Sections or Articles in this specification shall be construed to mean a specific Section or Article of the Standard Specifications for Road and Bridge Construction, adopted by the Department of Transportation.

**Railroad Protective Liability Insurance.** The contractor will be required to carry Railroad Protective Liability and Property Damage Liability Insurance in accordance with Article 107.11 of the Standard Specifications. A separate policy is required for each railroad indicated on the attached form unless otherwise noted. The limits of liability for each policy are listed on the attached form. The minimum limits of liability shall be in accordance with Article 107.11 of the Standard Specifications.

**Basis of Payment.** The costs for providing insurance, as noted above, will be paid for at the contract unit price per Lump Sum for RAILROAD PROTECTIVE LIABILITY INSURANCE.

APPROVAL OF INSURANCE: The ORIGINAL and one CERTIFIED copy of each required policy shall be submitted for approval to the following address:

\_\_\_\_\_  
\_\_\_\_\_  
\_\_\_\_\_  
\_\_\_\_\_

The contractor will be advised when approval of the insurance has been received from the railroad(s). Before any work begins on railroad right-of-way, the Contractor shall submit to the Resident Engineer evidence that the required railroad protective liability insurance has been approved by the railroad(s). The Contractor shall also provide the Resident Engineer with expiration date of each required policy.



**RAILROAD PROTECTIVE LIABILITY INSURANCE FORM**

<u>NAMED INSURED &amp; ADDRESS</u>	<u>NUMBER &amp; SPEED OF PASSENGER TRAINS</u>	<u>NUMBER &amp; SPEED OF FREIGHT TRAINS</u>
<b>Illinois Central Railroad Comp. Manager Engineering Service 17641 South Ashland Ave. Homewood, IL 60430-1345</b>	<b>6 @ 79MPH</b>	<b>18@ 40-79 MPH</b>
DOT/AAR Number: <u>289 099N</u> RR Mile Post: <u>139.33</u>		
Liability Limits: Combined Single Limit \$ _____ Aggregate Limit \$ _____		
For Freight/Passenger Information Contact: <u>Mr. Harvey Taylor</u> Phone: <u>217-238-2443</u>		
For Insurance Information Contact: <u>Mr. John Henriksen</u> Phone: <u>217-332-3557</u>		

DOT/AAR Number: _____		RR Mile Post: _____
Liability Limits: Combined Single Limit \$ _____		Aggregate Limit \$ _____
For Freight/Passenger Information Contact: _____		Phone: _____
For Insurance Information Contact: _____		Phone: _____

DOT/AAR Number: _____		RR Mile Post: _____
Liability Limits: Combined Single Limit \$ _____		Aggregate Limit \$ _____
For Freight/Passenger Information Contact: _____		Phone: _____
For Insurance Information Contact: _____		Phone: _____

DOT/AAR Number: _____		RR Mile Post: _____
Liability Limits: Combined Single Limit \$ _____		Aggregate Limit \$ _____
For Freight/Passenger Information Contact: _____		Phone: _____
For Insurance Information Contact: _____		Phone: _____

# Champaign County Prevailing Wage Rates posted on 1/6/2022

Trade Title	Rg	Type	C	Base	Foreman	Overtime				H/W	Pension	Vac	Trng	Other Ins
						M-F	Sa	Su	Hol					
ASBESTOS ABT-GEN	All	BLD		33.10	34.35	1.5	1.5	2.0	2.0	7.25	18.61	0.00	0.90	
ASBESTOS ABT-MEC	All	BLD		24.45	25.45	1.5	1.5	2.0	2.0	9.70	8.00	0.00	0.50	
BOILERMAKER	All	BLD		41.00	44.00	1.5	1.5	2.0	2.0	7.07	21.86	0.00	1.45	
BRICK MASON	All	BLD		34.16	35.87	1.5	1.5	2.0	2.0	9.00	15.95	0.00	0.89	
CARPENTER	All	BLD		37.83	40.08	1.5	1.5	2.0	2.0	9.20	15.75	0.00	0.74	
CARPENTER	All	HWY		37.85	39.60	1.5	1.5	2.0	2.0	9.20	17.77	0.00	0.71	
CEMENT MASON	All	BLD		34.81	37.31	1.5	1.5	2.0	2.0	9.85	11.70	0.00	0.50	
CEMENT MASON	All	HWY		35.90	37.90	1.5	1.5	2.0	2.0	9.85	12.30	0.00	0.50	
CERAMIC TILE FINISHER	All	BLD		32.77	32.77	1.5	1.5	2.0	2.0	9.00	11.95	0.00	0.40	
ELECTRIC PWR EQMT OP	All	ALL		49.37	58.58	1.5	1.5	2.0	2.0	8.23	13.82	0.00	0.74	
ELECTRIC PWR GRNDMAN	All	ALL		33.54	58.58	1.5	1.5	2.0	2.0	7.76	9.40	0.00	0.51	
ELECTRIC PWR LINEMAN	All	ALL		54.95	58.58	1.5	1.5	2.0	2.0	8.40	15.39	0.00	0.82	
ELECTRIC PWR TRK DRV	All	ALL		35.21	58.58	1.5	1.5	2.0	2.0	7.81	9.86	0.00	0.53	
ELECTRICIAN	All	BLD		43.83	48.21	1.5	1.5	2.0	2.0	7.25	10.92	0.00	0.66	
ELECTRONIC SYSTEM TECH	All	BLD		33.99	36.99	1.5	1.5	2.0	2.0	7.25	11.36	0.00	0.40	
ELEVATOR CONSTRUCTOR	All	BLD		51.01	57.39	2.0	2.0	2.0	2.0	16.02	20.21	4.08	0.65	
FENCE ERECTOR	All	ALL		34.85	36.85	1.5	1.5	2.0	2.0	11.74	14.00	0.00	1.11	
GLAZIER	All	BLD		37.00	39.00	1.5	1.5	2.0	2.0	6.95	11.47	0.00	0.68	
HEAT/FROST INSULATOR	All	BLD		33.90	35.40	1.5	1.5	2.0	2.0	7.14	13.49	0.00	0.35	0.55
IRON WORKER	All	ALL		34.85	36.85	1.5	1.5	2.0	2.0	11.74	14.00	0.00	1.11	
LABORER	All	BLD		30.60	31.85	1.5	1.5	2.0	2.0	7.25	18.61	0.00	0.80	
LABORER	All	HWY		33.43	34.43	1.5	1.5	2.0	2.0	7.25	18.73	0.00	0.80	
LATHER	All	BLD		37.83	40.08	1.5	1.5	2.0	2.0	9.20	15.75	0.00	0.74	
MACHINIST	All	BLD		50.68	53.18	1.5	1.5	2.0	2.0	8.93	8.95	1.85	1.47	
MARBLE FINISHER	All	BLD		32.77	32.77	1.5	1.5	2.0	2.0	9.00	11.95	0.00	0.40	
MARBLE MASON	All	BLD		34.29	34.29	1.5	1.5	2.0	2.0	9.00	11.95	0.00	0.40	
MILLWRIGHT	All	BLD		33.60	35.85	1.5	1.5	2.0	2.0	9.20	20.44	0.00	0.74	
MILLWRIGHT	All	HWY		37.36	39.11	1.5	1.5	2.0	2.0	9.20	21.21	0.00	0.71	
OPERATING ENGINEER	All	ALL	1	42.75	43.75	1.5	1.5	2.0	2.0	10.85	11.95	0.00	1.30	
OPERATING ENGINEER	All	ALL	2	27.65	43.75	1.5	1.5	2.0	2.0	10.85	11.95	0.00	1.30	
OPERATING ENGINEER	All	ALL	3	43.75	44.75	1.5	1.5	2.0	2.0	10.85	11.95	0.00	1.30	

PAINTER	All	ALL		36.56	38.06	1.5	1.5	2.0	2.0	9.85	7.28	0.00	0.60	
PAINTER - SIGNS	All	ALL		36.56	38.06	1.5	1.5	2.0	2.0	9.85	7.28	0.00	0.60	
PILEDRIIVER	All	BLD		38.83	41.08	1.5	1.5	2.0	2.0	9.20	15.75	0.00	0.74	
PILEDRIIVER	All	HWY		37.85	39.60	1.5	1.5	2.0	2.0	9.20	17.77	0.00	0.71	
PIPEFITTER	All	BLD		47.10	50.02	1.5	1.5	2.0	2.0	8.25	10.89	0.00	2.10	0.10
PLASTERER	All	BLD		35.05	37.05	1.5	1.5	2.0	2.0	9.85	13.29	0.00	0.50	
PLUMBER	All	BLD		47.10	50.02	1.5	1.5	2.0	2.0	8.25	10.89	0.00	2.10	0.10
ROOFER	All	BLD		35.00	38.00	1.5	1.5	2.0	2.0	9.99	9.01	0.00	0.56	
SHEETMETAL WORKER	All	BLD		39.80	42.05	1.5	1.5	2.0	2.0	9.55	15.91	0.00	0.55	1.96
SPRINKLER FITTER	All	BLD		43.45	46.45	1.5	1.5	2.0	2.0	10.55	14.22	0.00	0.52	
STONE MASON	All	BLD		34.16	35.87	1.5	1.5	2.0	2.0	9.00	15.95	0.00	0.89	
TERRAZZO FINISHER	All	BLD		32.77	32.77	1.5	1.5	2.0	2.0	9.00	11.95	0.00	0.40	
TERRAZZO MASON	All	BLD		34.29	34.29	1.5	1.5	2.0	2.0	9.00	11.95	0.00	0.40	
TILE MASON	All	BLD		34.29	34.29	1.5	1.5	2.0	2.0	9.00	11.95	0.00	0.40	
TRUCK DRIVER	All	ALL	1	39.85	44.21	1.5	1.5	2.0	2.0	14.02	6.89	0.00	0.25	
TRUCK DRIVER	All	ALL	2	40.44	44.21	1.5	1.5	2.0	2.0	14.02	6.89	0.00	0.25	
TRUCK DRIVER	All	ALL	3	40.71	44.21	1.5	1.5	2.0	2.0	14.02	6.89	0.00	0.25	
TRUCK DRIVER	All	ALL	4	41.10	44.21	1.5	1.5	2.0	2.0	14.02	6.89	0.00	0.25	
TRUCK DRIVER	All	ALL	5	42.20	44.21	1.5	1.5	2.0	2.0	14.02	6.89	0.00	0.25	
TRUCK DRIVER	All	O&C	1	31.88	35.37	1.5	1.5	2.0	2.0	14.02	6.89	0.00	0.25	
TRUCK DRIVER	All	O&C	2	32.35	35.37	1.5	1.5	2.0	2.0	14.02	6.89	0.00	0.25	
TRUCK DRIVER	All	O&C	3	32.57	35.37	1.5	1.5	2.0	2.0	14.02	6.89	0.00	0.25	
TRUCK DRIVER	All	O&C	4	32.88	35.37	1.5	1.5	2.0	2.0	14.02	6.89	0.00	0.25	
TRUCK DRIVER	All	O&C	5	33.76	35.37	1.5	1.5	2.0	2.0	14.02	6.89	0.00	0.25	
TUCKPOINTER	All	BLD		34.16	35.87	1.5	1.5	2.0	2.0	9.00	15.95	0.00	0.89	

### **Legend**

**Rg** Region

**Type** Trade Type - All,Highway,Building,Floating,Oil & Chip,Rivers

**C** Class

**Base** Base Wage Rate

**OT M-F** Unless otherwise noted, OT pay is required for any hour greater than 8 worked each day, Mon through Fri. The number listed is the multiple of the base wage.

**OT Sa** Overtime pay required for every hour worked on Saturdays

**OT Su** Overtime pay required for every hour worked on Sundays

**OT Hol** Overtime pay required for every hour worked on Holidays

**H/W** Health/Welfare benefit

**Vac** Vacation

## **Trng Training**

**Other Ins** Employer hourly cost for any other type(s) of insurance provided for benefit of worker.

### **Explanations CHAMPAIGN COUNTY**

The following list is considered as those days for which holiday rates of wages for work performed apply: New Years Day, Memorial Day, Fourth of July, Labor Day, Thanksgiving Day, Christmas Day and Veterans Day in some classifications/counties. Generally, any of these holidays which fall on a Sunday is celebrated on the following Monday. This then makes work performed on that Monday payable at the appropriate overtime rate for holiday pay. Common practice in a given local may alter certain days of celebration. If in doubt, please check with IDOL.

Oil and chip resealing (O&C) means the application of road oils and liquid asphalt to coat an existing road surface, followed by application of aggregate chips or gravel to coated surface, and subsequent rolling of material to seal the surface.

### **EXPLANATION OF CLASSES**

**ASBESTOS - GENERAL** - removal of asbestos material/mold and hazardous materials from any place in a building, including mechanical systems where those mechanical systems are to be removed. This includes the removal of asbestos materials/mold and hazardous materials from ductwork or pipes in a building when the building is to be demolished at the time or at some close future date.

**ASBESTOS - MECHANICAL** - removal of asbestos material from mechanical systems, such as pipes, ducts, and boilers, where the mechanical systems are to remain.

### **CERAMIC TILE FINISHER, MARBLE FINISHER, TERRAZZO FINISHER**

Assisting, helping or supporting the tile, marble and terrazzo mechanic by performing their historic and traditional work assignments required to complete the proper installation of the work covered by said crafts. The term "Ceramic" is used for naming the classification only and is in no way a limitation of the product handled. Ceramic takes into consideration most hard tiles.

### **ELECTRONIC SYSTEMS TECHNICIAN**

Installation, service and maintenance of low-voltage systems which utilizes the transmission and/or transference of voice, sound, vision, or digital for commercial, education, security and entertainment purposes for the following: TV monitoring and surveillance, background/foreground music, intercom and telephone interconnect, field programming, inventory control systems, microwave transmission, multi-media, multiplex, radio page, school, intercom and sound burglar alarms and low voltage master clock systems.

Excluded from this classification are energy management systems, life safety systems, supervisory controls and data acquisition systems not intrinsic with the above listed systems, fire alarm systems, nurse call systems and raceways exceeding fifteen feet in length.

**TRUCK DRIVER - BUILDING, HEAVY AND HIGHWAY CONSTRUCTION Class 1.** Drivers on 2 axle trucks hauling less than 9 ton. Air compressor and welding machines and brooms, including those pulled by separate units, truck driver helpers, warehouse employees, mechanic helpers, greasers and tiremen, pickup trucks when hauling materials, tools, or workers to and from and on-the-job site, and fork lifts up to 6,000 lb. capacity.

**Class 2.** Two or three axle trucks hauling more than 9 ton but hauling less than 16 ton. A-frame winch trucks, hydrolift trucks, vactor trucks or similar equipment when used for transportation purposes. Fork lifts over 6,000 lb. capacity, winch trucks, four



axle combination units, and ticket writers.

Class 3. Two, three or four axle trucks hauling 16 ton or more. Drivers on water pulls, articulated dump trucks, mechanics and working forepersons, and dispatchers. Five axle or more combination units.

Class 4. Low Boy and Oil Distributors.

Class 5. Drivers who require special protective clothing while employed on hazardous waste work.

#### TRUCK DRIVER - OIL AND CHIP RESEALING ONLY.

This shall encompass laborers, workers and mechanics who drive contractor or subcontractor owned, leased, or hired pickup, dump, service, or oil distributor trucks. The work includes transporting materials and equipment (including but not limited to, oils, aggregate supplies, parts, machinery and tools) to or from the job site; distributing oil or liquid asphalt and aggregate; stock piling material when in connection with the actual oil and chip contract. The Truck Driver (Oil & Chip Resealing) wage classification does not include supplier delivered materials.

OPERATING ENGINEERS - BUILDING, HEAVY AND HIGHWAY CONSTRUCTION Class 1. Draglines, Derricks, Shovels, Gradalls, Mechanics, Tractor Highlift, Tournadozer, Concrete Mixers with Skip, Tournamixer, Two Drum Machine, One Drum Hoist with Tower or Boom, Cableways, Tower Machines, Motor Patrol, Boom Tractor, Boom or Winch Truck, Winch or Hydraulic Boom Truck, Tournapull, Tractor Operating Scoops, Bulldozer, Push Tractor, Asphalt Planer, Finishing Machine on Asphalt, Large Rollers on Earth, Rollers on Asphalt Mix, Ross Carrier or similar Machine, Gravel Processing Machine, Asphalt Plant Engineer, Paver Operator, Dredging Equipment, or Dredge Engineer, or Dredge Operator, Central Mix Plant Engineer, CMI or similar type machine, Concrete Pump, Truck or Skid Mounted, Engineer or Rock Crusher Plant, Concrete Plant Engineer, Ditching Machine with dual attachment, Tractor Mounted Loaders, Hydro Crane, Standard or Dinkey Locomotives, Scoopmobiles, Euclid Loader, Soil Cement Machine, Back Filler, Elevating Machine, Power Blade, Drilling Machine, including Well Testing, Caissons, Shaft or any similar type drilling machines, Motor Driven Paint Machine, Pipe Cleaning Machine, Pipe Wrapping Machine, Pipe Bending Machine, Apsco Paver, Boring Machine, (Head Equipment Greaser), Barber-Greene Loaders, Formless Paver, (Well Point System), Concrete Spreader, Hydra Ax, Span Saw, Marine Scoops, Brush Mulcher, Brush Burner, Mesh Placer, Tree Mover, Helicopter Crew (3), Piledriver-Skid or Crawler, Stump Remover, Root Rake, Tug Boat Operator, Refrigerating Machine, Freezing Operator, Chair Cart- Self-Propelled, Hydra Seeder, Straw Blower, Power Sub Grader, Bull Float, Finishing Machine, Self-Propelled Pavement Breaker, Lull (or similar type Machine), Two Air Compressors, Compressors hooked in Manifold, Chip Spreader, Mud Cat, Sull-Air, Fork Lifts (except when used for landscaping work), Soil Stabilizer (Seaman Tiller, Bo Mag, Rago Gator, and similar types of equipment), Tube Float, Spray Machine, Curing Machine, Concrete or Asphalt Milling Machine, Snooper Truck-Operator, Backhoe, Farm Tractors (with attachments), 4 Point Lift System (Power Lift or similar type), Skid-Steer (Bob Cat or similar type), Wrecking Shears, Water Blaster.

Class 2. Concrete Mixers without Skips, Rock Crusher, Ditching Machine under 6', Curbing Machine, One Drum Machines without Tower or Boom, Air Tugger, Self-Propelled Concrete Saw, Machine Mounted Post Hole Digger, two to four Generators, Water Pumps or Welding Machines, within 400 feet, Air Compressor 600 cu. ft. and under, Rollers on Aggregate and Seal Coat Surfaces, Fork Lift (when used for landscaping work), Concrete and Blacktop Curb Machine, One Water Pump, Oilers, Air Valves or Steam Valves, One Welding Machine, Truck Jack, Mud Jack, Gunnite Machine, House Elevators when used for hoisting material, Engine Tenders, Fireman, Wagon Drill, Flex Plane, Conveyor, Siphons and Pulsometer, Switchman, Fireman on Paint Pots, Fireman on Asphalt Plants, Distributor Operator on Trucks, Tampers, Self-Propelled Power Broom, Striping Machine (motor driven), Form Tamper, Bulk Cement Plant, Equipment Greaser, Deck Hands, Truck Crane Oiler-Driver, Cement Blimps, Form Grader, Temporary Heat, Throttle Valve, Super Sucker (and similar type of equipment).

Class 3. Power Cranes, Truck or Crawler Crane, Rough Terrain Crane (Cherry Picker), Tower Crane, Overhead Crane.

Other Classifications of Work:

For definitions of classifications not otherwise set out, the Department generally has on file such definitions which are available. If

a task to be performed is not subject to one of the classifications of pay set out, the Department will upon being contacted state which neighboring county has such a classification and provide such rate, such rate being deemed to exist by reference in this document. If no neighboring county rate applies to the task, the Department shall undertake a special determination, such special determination being then deemed to have existed under this determination. If a project requires these, or any classification not listed, please contact IDOL at 217-782-1710 for wage rates or clarifications.

#### LANDSCAPING

Landscaping work falls under the existing classifications for laborer, operating engineer and truck driver. The work performed by landscape plantsman and landscape laborer is covered by the existing classification of laborer. The work performed by landscape operators (regardless of equipment used or its size) is covered by the classifications of operating engineer. The work performed by landscape truck drivers (regardless of size of truck driven) is covered by the classifications of truck driver.

**BDE SPECIAL PROVISIONS**  
For the August 5, 2022 and September 23, 2022 Lettings

The following special provisions indicated by a "check mark" are applicable to this contract and will be included by the Project Coordination and Implementation Section of the BD&E. An \* indicates a new or revised special provision for the letting.

File Name	#		Special Provision Title	Effective	Revised
	80099	1	<input type="checkbox"/> Accessible Pedestrian Signals (APS)	April 1, 2003	Jan. 1, 2022
	80274	2	<input type="checkbox"/> Aggregate Subgrade Improvement	April 1, 2012	April 1, 2022
	80192	3	<input type="checkbox"/> Automated Flagging Assistance Device	Jan. 1, 2008	
	80173	4	<input type="checkbox"/> Bituminous Materials Cost Adjustments	Nov. 2, 2006	Aug. 1, 2017
	80426	5	<input type="checkbox"/> Bituminous Surface Treatment with Fog Seal	Jan. 1, 2020	Jan. 1, 2022
	80436	6	<input type="checkbox"/> Blended Finely Divided Minerals	April 1, 2021	
	80241	7	<input type="checkbox"/> Bridge Demolition Debris	July 1, 2009	
*	50531	8	<input type="checkbox"/> Building Removal	Sept. 1, 1990	Aug. 1, 2022
*	50261	9	<input type="checkbox"/> Building Removal with Asbestos Abatement	Sept. 1, 1990	Aug. 1, 2022
	80384	10	<input checked="" type="checkbox"/> Compensable Delay Costs	June 2, 2017	April 1, 2019
	80198	11	<input type="checkbox"/> Completion Date (via calendar days)	April 1, 2008	
	80199	12	<input type="checkbox"/> Completion Date (via calendar days) Plus Working Days	April 1, 2008	
	80293	13	<input type="checkbox"/> Concrete Box Culverts with Skews > 30 Degrees and Design Fills ≤ 5 Feet	April 1, 2012	July 1, 2016
	80311	14	<input type="checkbox"/> Concrete End Sections for Pipe Culverts	Jan. 1, 2013	April 1, 2016
	80261	15	<input type="checkbox"/> Construction Air Quality – Diesel Retrofit	June 1, 2010	Nov. 1, 2014
	80434	16	<input type="checkbox"/> Corrugated Plastic Pipe (Culvert and Storm Sewer)	Jan. 1, 2021	
	80029	17	<input type="checkbox"/> Disadvantaged Business Enterprise Participation	Sept. 1, 2000	March 2, 2019
	80229	18	<input type="checkbox"/> Fuel Cost Adjustment	April 1, 2009	Aug. 1, 2017
	80433	19	<input type="checkbox"/> Green Preformed Thermoplastic Pavement Markings	Jan. 1, 2021	Jan. 1, 2022
	80422	20	<input type="checkbox"/> High Tension Cable Median Barrier	Jan. 1, 2020	Jan. 1, 2022
	80443	21	<input type="checkbox"/> High Tension Cable Median Barrier Removal	April 1, 2022	
*	80442	22	<input type="checkbox"/> Hot-Mix Asphalt	Jan. 1, 2022	Aug. 1, 2022
	80444	23	<input type="checkbox"/> Hot-Mix Asphalt - Patching	April 1, 2022	
	80438	24	<input type="checkbox"/> Illinois Works Apprenticeship Initiative – State Funded Contracts	June 2, 2021	Sept. 2, 2021
	80411	25	<input type="checkbox"/> Luminaires, LED	April 1, 2019	Jan. 1, 2022
	80045	26	<input type="checkbox"/> Material Transfer Device	June 15, 1999	Jan. 1, 2022
	80418	27	<input type="checkbox"/> Mechanically Stabilized Earth Retaining Walls	Nov. 1, 2019	Nov. 1, 2020
	80430	28	<input type="checkbox"/> Portland Cement Concrete – Haul Time	July 1, 2020	
	34261	29	<input type="checkbox"/> Railroad Protective Liability Insurance	Dec. 1, 1986	Jan. 1, 2022
	80395	30	<input type="checkbox"/> Sloped Metal End Section for Pipe Culverts	Jan. 1, 2018	
	80340	31	<input type="checkbox"/> Speed Display Trailer	April 2, 2014	Jan. 1, 2022
	80127	32	<input type="checkbox"/> Steel Cost Adjustment	April 2, 2004	Jan. 1, 2022
	80397	33	<input type="checkbox"/> Subcontractor and DBE Payment Reporting	April 2, 2018	
	80391	34	<input checked="" type="checkbox"/> Subcontractor Mobilization Payments	Nov. 2, 2017	April 1, 2019
	80437	35	<input type="checkbox"/> Submission of Payroll Records	April 1, 2021	
	80435	36	<input type="checkbox"/> Surface Testing of Pavements – IRI	Jan. 1, 2021	Jan. 1, 2022
	80410	37	<input type="checkbox"/> Traffic Spotters	Jan. 1, 2019	
	20338	38	<input type="checkbox"/> Training Special Provisions	Oct. 15, 1975	Sept. 2, 2021
	80318	39	<input type="checkbox"/> Traversable Pipe Grate for Concrete End Sections	Jan. 1, 2013	Jan. 1, 2018
	80429	40	<input type="checkbox"/> Ultra-Thin Bonded Wearing Course	April 1, 2020	Jan. 1, 2022
	80440	41	<input type="checkbox"/> Waterproofing Membrane System	Nov. 1, 2021	
	80302	42	<input type="checkbox"/> Weekly DBE Trucking Reports	June 2, 2012	Nov. 1, 2021
	80427	43	<input checked="" type="checkbox"/> Work Zone Traffic Control Devices	Mar. 2, 2020	
	80071	44	<input checked="" type="checkbox"/> Working Days	Jan. 1, 2002	

The following special provisions have been deleted from use.

File Name	Special Provision Title	Effective	Revised
50481	Building Removal-Case II (Non-Friable Asbestos)	Sept. 1, 1990	April 1, 2010
50491	Building Removal-Case III (Friable Asbestos)	Sept. 1, 1990	April 1, 2010
80439	Vehicle and Equipment Warning Lights	Nov. 1, 2021	

The following special provisions are in the 2022 Standard Specifications and Recurring Special Provisions.

<u>File Name</u>	<u>Special Provision Title</u>	<u>New Location(s)</u>	<u>Effective</u>	<u>Revised</u>
80425	Cape Seal	Sections 405, 1003	Jan. 1, 2020	Jan. 1, 2021
80387	Contrast Preformed Plastic Pavement Marking	Articles 780.08, 1095.03	Nov. 1, 2017	
80402	Disposal Fees	Article 109.04(b)	Nov. 1, 2018	
80378	Dowel Bar Inserter	Articles 420.03, 420.05, 1103.20	Jan. 1, 2017	Jan. 1, 2018
80421	Electric Service Installation	Articles 804.04, 804.05	Jan. 1, 2020	
80415	Emulsified Asphalts	Article 1032.06	Aug. 1, 2019	
80423	Engineer's Field Office and Laboratory	Section 670	Jan. 1, 2020	
80417	Geotechnical Fabric for Pipe Underdrains and French Drains	Articles 1080.01(a), 1080.05	Nov. 1, 2019	
80420	Geotextile Retaining Walls	Article 1080.06(d)	Nov. 1, 2019	
80304	Grooving for Recessed Pavement Markings	Articles 780.05, 780.14, 780.15	Nov. 1, 2012	Nov. 1, 2020
80416	Hot-Mix Asphalt – Binder and Surface Course	Sections 406, 1003, 1004, 1030, 1101	July 2, 2019	Nov. 1, 2019
80398	Hot-Mix Asphalt – Longitudinal Joint Sealant	Sections 406, 1032	Aug. 1, 2018	Nov. 1, 2019
80406	Hot-Mix Asphalt – Mixture Design Verification and Production (Modified for I-FIT)	Sections 406, 1030	Jan. 1, 2019	Jan. 2, 2021
80347	Hot-Mix Asphalt – Pay for Performance Using Percent Within Limits – Jobsite Sampling	Sections 406, 1030	Nov. 1, 2014	July 2, 2019
80383	Hot-Mix Asphalt – Quality Control for Performance	Sections 406, 1030	April 1, 2017	July 2, 2019
80393	Manholes, Valve Vaults, and Flat Slab Tops	Articles 602.02, 1042.10	Jan. 1, 2018	Mar. 1, 2019
80424	Micro-Surfacing and Slurry Sealing	Sections 404, 1003	Jan. 1, 2020	Jan. 1, 2021
80428	Mobilization	Article 671.02	April 1, 2020	
80412	Obstruction Warning Luminaires, LED	Sections 801, 822, 1067	Aug. 1, 2019	
80359	Portland Cement Concrete Bridge Deck Curing	Articles 1020.13, 1022.03	April 1, 2015	Nov. 1, 2019
80431	Portland Cement Concrete Pavement Patching	Articles 701.17(e)(3)b, 1001.01(d), 1020.05(b)(5)	July 1, 2020	
80432	Portland Cement Concrete Pavement Placement	Article 420.07	July 1, 2020	
80300	Preformed Plastic Pavement Marking Type D - Inlaid	Articles 780.08, 1095.03	April 1, 2012	April 1, 2016
80157	Railroad Protective Liability Insurance (5 and 10)	Article 107.11	Jan. 1, 2006	
80306	Reclaimed Asphalt Pavement (RAP) and Reclaimed Asphalt Shingles (RAS)	Section 1031	Nov. 1, 2012	Jan. 2, 2021
80407	Removal and Disposal of Regulated Substances	Section 669	Jan. 1 2019	Jan. 1, 2020
80419	Silt Fence, Inlet Filters, Ground Stabilization and Riprap Filter Fabric	Articles 280.02, 280.04, 1080.02, 1080.03, 1081.15	Nov. 1, 2019	July 1, 2021
80408	Steel Plate Beam Guardrail Manufacturing	Article 1006.25	Jan. 1, 2019	
80413	Structural Timber	Article 1007.03	Aug. 1, 2019	
80298	Temporary Pavement Marking	Section 703, Article 1095.06	April 1, 2012	April 1, 2017
80409	Traffic Control Devices – Cones	Article 701.15(a), 1106.02(b)	Jan. 1, 2019	
80288	Warm Mix Asphalt	Sections 406, 1030, 1102	Jan. 1, 2012	April 1, 2016
80414	Wood Fence Sight Screen	Article 641.02	Aug. 1, 2019	April 1, 2020

The following special provisions require additional information from the designer. The additional information needs to be submitted as a separate document. The Project Coordination and Implementation section will then include the information in the applicable special provision.

- Bridge Demolition Debris
- Building Removal
- Building Removal with Asbestos Abatement
- Completion Date
- Completion Date Plus Working Days
- DBE Participation
- Railroad Protective Liability Insurance
- Training Special Provisions
- Working Days

**WORKING DAYS (BDE)**

**Effective: January 1, 2002**

**The Contractor shall complete the work within 20 working days.**

**80071**



**STATE OF ILLINOIS  
DEPARTMENT OF TRANSPORTATION  
DIVISION OF HIGHWAYS  
PROPOSED  
HIGHWAY PLANS  
TR 307 (100N CR)  
SECTION #06-18408-00-SP  
FUNDING - GRADE CROSSING PROTECTION FUND  
CHAMPAIGN COUNTY**

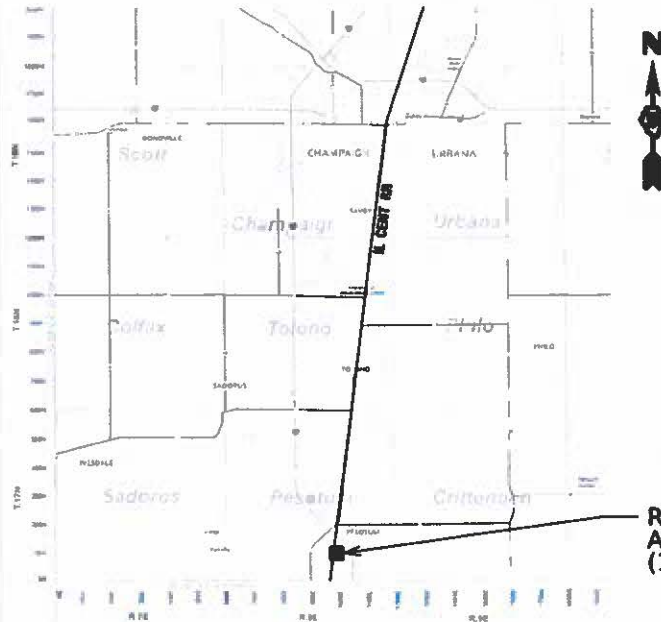

**T17N, R8E, 3RD PM**

**LOCATION: ILLINOIS CENTRAL RAILROAD CROSSING ON CR 100N IN PESOTUM TOWNSHIP.**

**FOR INDEX SHEETS AND STANDARDS, SEE SHEETS 39-53**

**FOR SUMMARY OF QUANTITIES, SEE SHEET 34**

**TOWNSHIP: PESOTUM**

**GROSS LENGTH (AND NET) = 525 FT = 0.10 MILE**

**FUNCTIONAL CLASSIFICATION: LOCAL ROAD**

**ADT: 50 (2016)**



*[Signature]* **12/20/22**  
DATE  
JOHN J. BLUE, P.E.  
ILLINOIS REGISTERED PROFESSIONAL ENGINEER  
NO. 062-049267, EXPIRES NOVEMBER 30, 2023



**J.U.L.I.E.  
JOINT UTILITY LOCATION INFORMATION FOR EXCAVATION  
1-800-892-0123  
OR 811**

APPROVED **12/20/22**  
*[Signature]*  
CHAMPAIGN COUNTY ENGINEER

PASSED **January 4, 2022**  
*[Signature]*  
DISTRICT FIVE ENGINEER OF LOCAL ROADS & STREETS

RELEASING FOR  
BID BASED ON  
LIMITED REVIEW **January 4, 2023**  
*[Signature]*  
REGION THREE ENGINEER

STATE OF ILLINOIS  
DEPARTMENT OF TRANSPORTATION

TEMP BENCHMARK: WEST RAIL @ THE  
INTERSECTION WITH THE C OF T.R 307 (ELEV. 100.00)

SECTION	COUNTY	TOT SHTS	SHT NO
06-18408-00-SP	CHAMPAIGN	1	2
PESOTUM TOWNSHIP - TR 307			

0 25 50  
SCALE IN FEET

Begin Project  
Sta. 7+37.5

50' Transition  
To Existing

EXIST. R.O.W.

EXIST. R.O.W.

ILLINOIS CENTRAL RR

EXIST. R.O.W.

EXIST. R.O.W.

Sta. 12+12.5

End Project  
Sta. 12+62.5

0 25 50  
SCALE IN FEET

50' Transition  
To Existing

EXIST. R.O.W.

EXIST. C TR 307

EXIST. R.O.W.

EXIST. R.O.W.

EXIST. R.O.W.

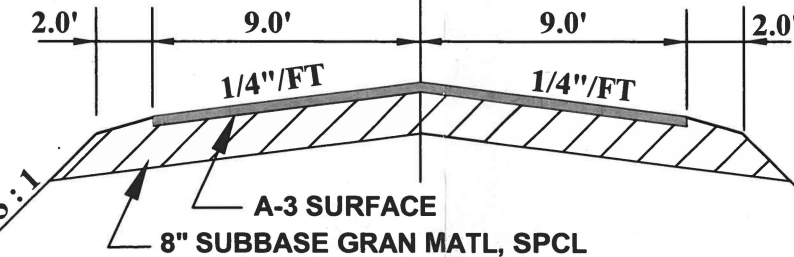

PROPOSED TYPICAL SECTION

QUANTITIES - TR 307 (100N, 990E)

FURNISHED EXCAV	370.0 CU. YD.
SUBBASE GRAN MATL, SPCL	500.0 TON
BITUM MATL(PRIME)	2.0 TON
BITUM MATL(SEAL & COVER)	4.0 TON
SEAL COAT AGGREG	15.0 TON
COVER COAT AGGREG	30.0 TON
TRAF CONT & PROT	1.0 EACH
RAILROAD FLAGGER	5.0 CAL DAY
RR PROT LIABILITY INS	1.0 LUMP SUM
SCARIFY EXISTING SURFACE	1050.0 SQ. YD.

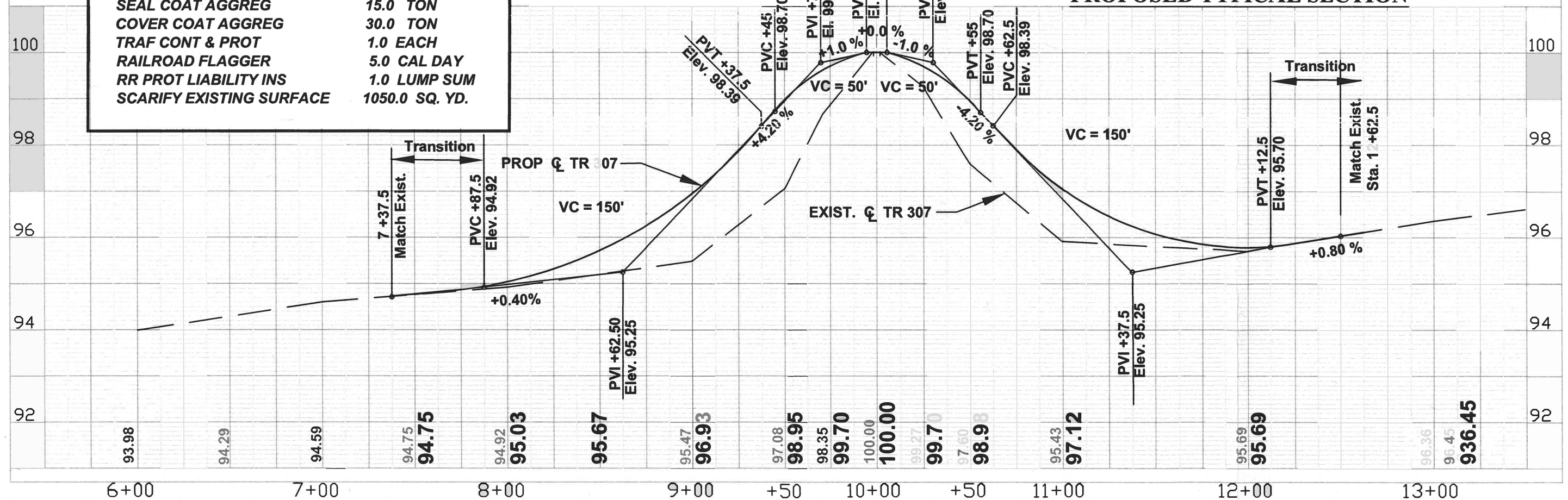



(100N)

SECTION	COUNTY	TOT SHT
TR 307	06-18408-00-SF CHAMPAGN	2
STA 8+00 - STA 12+00		2

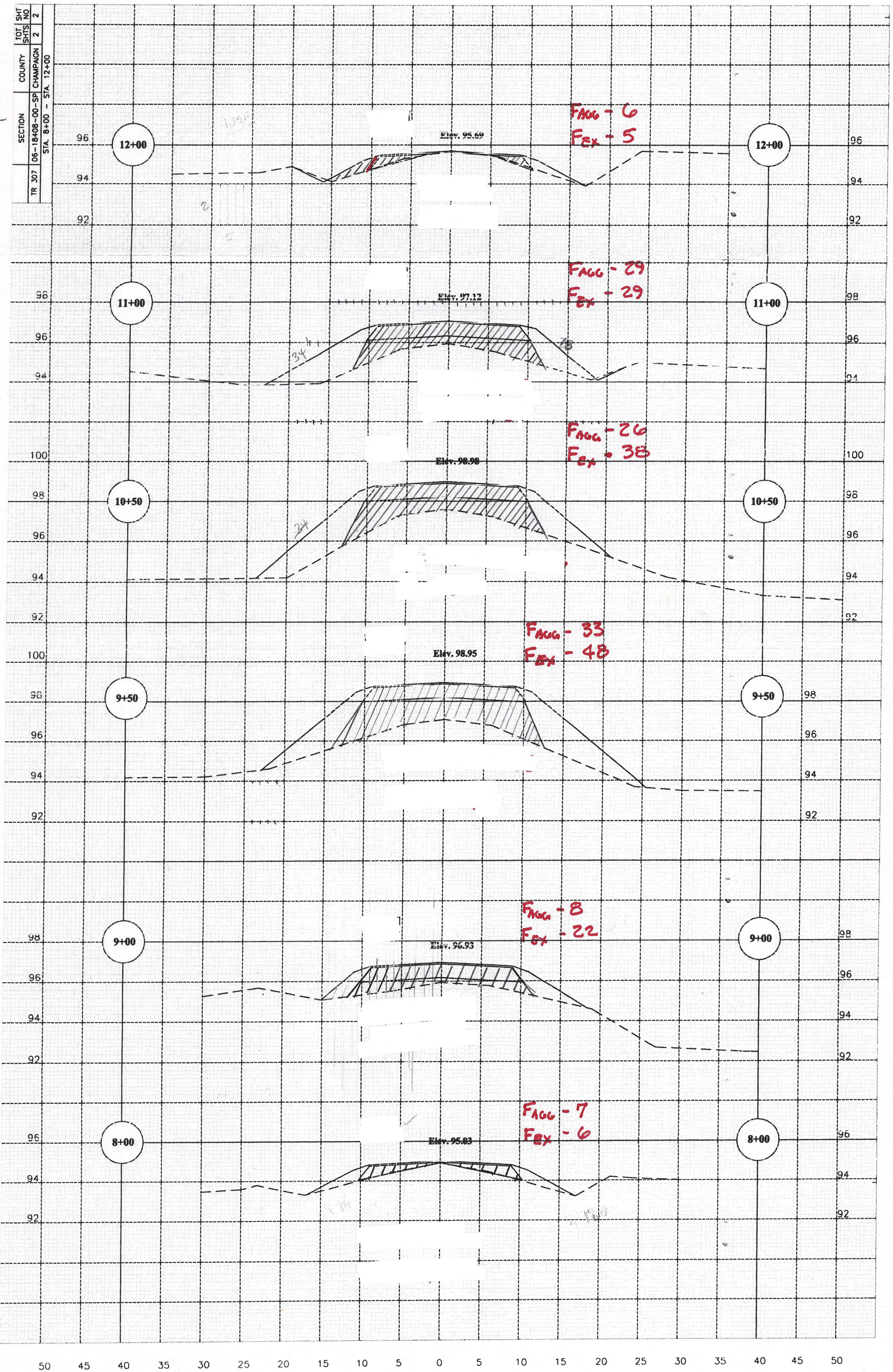



ABV	ABOVE	CU YD	CUBIC YARD	HATCH	HATCHING	PM	PAVEMENT MARKING	STD	STANDARD
ACC	ACCESS CONTROL	CULV	CULVERT	HD	HEAD	PED	PEDESTAL	SBI	STATE BOND ISSUE
AC	ACRE	C&G	CURB & GUTTER	MDW	HEADWALL	PNT	POINT	SR	STATE ROUTE
ADJ	ADJUST	D	DEGREE OF CURVE	MDUTY	HEAVY DUTY	PC	POINT OF CURVATURE	STA	STATION
AS	AERIAL SURVEYS	DC	DEPRESSED CURVE	na	HECTARE	PI	POINT OF INTERSECTION OF HORIZONTAL CURVE	SPBGR	STEEL PLATE BEAM GUARDRAIL
ACG	AGGREGATE	DET	DETECTOR	HMA	HOT MIX ASPHALT			SS	STORM SEWER
AM	AHEAD	DIA	DIAMETER	HWM	HIGHWAY	PRC	POINT OF REVERSE CURVE	STY	STORY
APT	APARTMENT	DIST	DISTRICT	HORIZ	HORIZONTAL	PT	POINT OF TANGENCY	ST	STREET
ASPM	ASPHALT	DOM	DOMESTIC	HSE	HOUSE	POT	POINT ON TANGENT	STR	STRUCTURE
AUX	AUXILIARY	DBL	DOUBLE	IL	ILLINOIS	POLYETH	POLYETHYLENE	e	SUPERELEVATION RATE
AGS	AUXILIARY GAS VALVE (SERVICE)	DSEL	DOWNSIDE ELEVATION	IMP	IMPROVEMENT	PCC	PORTLAND CEMENT CONCRETE	S.E. RUN.	SUPERELEVATION RUNOFF LENGTH
AVE	AVENUE	DSFL	DOWNSIDE FLOWLINE	IN DIA	INCH DIAMETER	PP	POWER POLE OR PRINCIPAL POINT	SURF	SURFACE
AX	AXIS OF ROTATION	DR	DRAINAGE OR DRIVE	INL	INLET	PRM	PRIVATE ENTRANCE	SMK	SURVEY MARKER
BK	BACK	DI	DRAINAGE INLET OR DROP INLET	INST	INSTALLATION	PE	PROFILE	T	TANGENT DISTANCE
B-B	BACK TO BACK	DRV	DRIVEWAY	ID5	INTERSECTION DESIGN STUDY	PROF	PROFILE GRADELINE	T.R.	TANGENT RUNOUT DISTANCE
BKPL	BACKPLATE	DCT	DUCT	INV	INVERT	PGL	PROJECT	TEL	TELEPHONE
B	BARN	EA	EACH	IP	IRON PIPE	PROJ	PROPERTY CORNER	TB	TELEPHONE BOX
BARR	BARRICADE	EB	EASTBOUND	IR	IRON ROD	P.C.	PROPERTY LINE	TP	TEMPORARY
BL	BASELINE	EOP	EDGE OF PAVEMENT	IT	JOINT	PL	PROPOSED	TEMP	TEMPORARY
BGN	BEGIN	E-CL	EDGE TO CENTERLINE	kg	KILOGRAM	PR	RADIUS OF RESIDENTIAL	TBM	TEMPORARY BENCH MARK
BM	BENCHMARK	E-E	EDGE TO EDGE	km	KILOMETER	R	RAILROAD	TD	TILE DRAIN
BIND	BINDER	ELEC	ELECTRICAL	LS	LANDSCAPING	RR	RAILROAD SPIKE	TBE	TO BE EXTENDED
BIT	BITUMINOUS	EL	ELEVATION	LJ	LANE	RAS	REFERENCE POINT STAKE	TBR	TO BE REMOVED
BTM	BOTTOM	ENTR	ENTRANCE	LT	LEFT	RPS	REFLECTIVE	TBS	TO BE SAVED
BLVD	BOULEVARD	EXC	EXCAVATION	LJAR	LIGHT DETECTION AND RANGING	REF	REINFORCED CONCRETE CULVERT PIPE	TWP	TOWNSHIP
BRK	BRICK	EX	EXISTING	LP	LIGHT POLE	RCCP	REINFORCEMENT	TR	TOWNSHIP ROAD
BBOX	BUFFALO BOX	EXPWAY	EXPRESSWAY	LGT	LIGHTING	RECF	REINFORCEMENT	TS	TRAFFIC SIGNAL
BLOG	BUILDING	E	EXTERNAL DISTANCE OF HORIZONTAL CURVE	LF	LINEAL FEET OR LINEAR FEET	REM	REMOVAL	TSCB	TRAFFIC SIGNAL CONTROL BOX
CATV	CABLE	E	OFFSET DISTANCE TO VERTICAL CURVE	L	LITER OR CURVE LENGTH	RC	REMOVE CROWN	TSC	TRAFFIC SYSTEMS CENTER
CIP	CAST IRON PIPE	F-F	FACE TO FACE	LC	LONG CHORD	REP	REPLACEMENT	TRVS	TRANSVERSE
CB	CATCH BASIN	FA	FEDERAL AID	LNG	LONGITUDINAL	REST	RESTAURANT	TRVL	TRAVEL
C-C	CENTER TO CENTER	FAI	FEDERAL AID INTERSTATE	L SUM	LUMP SUM	RESURF	RESURFACING	TRN	TURN
CL	CENTERLINE OR CLEARANCE	FAP	FEDERAL AID PRIMARY	MACH	MACHINE	RET	RETAINING	TY	TYPE
CL-E	CENTERLINE TO EDGE	FAS	FEDERAL AID SECONDARY	MB	MAIL BOX	RT	RIGHT	T-A	TYPE A
CL-F	CENTERLINE TO FACE	FAUS	FEDERAL AID URBAN SECONDARY	MH	MANHOLE	ROW	RIGHT-OF-WAY	TYP	TYPICAL
CTS	CENTERS	FP	FENCE POST	MATL	MATERIAL	RD	ROAD	UNDERGND	UNDERGROUND
CERT	CERTIFIED	OPT	FIBER OPTIC	MED	MEDIAN	RDWY	ROADWAY	USGS	U.S. GEOLOGICAL SURVEY
CMSLD	CISELED	FE	FIELD ENTRANCE	m	METER	ROUTE	ROUTE	USEL	UPSTREAM ELEVATION
CS	CITY STREET	FM	FIRE HYDRANT	METH	METHOD	SAN	SANITARY	USFL	UPSTREAM FLOWLINE
CP	CLAY PIPE	FL	FLOW LINE	M	MID-ORDINATE	SANS	SANITARY SEWER	UTIL	UTILITY
CLSD	CLOSED	FB	FOOT BRIDGE	mm	MILLIMETER	SEC	SECTION	VBOX	VALVE BOX
CLUD	CLOSED LID	FDN	FOUNDATION	mm DIA	MILLIMETER DIAMETER	SEED	SEEDING	VV	VALVE VAULT
CT	COAT OR COURT	FR	FRAME	MIX	MIXTURE	SHAP	SHAPING	VLT	VAULT
COMB	COMBINATION	F&G	FRAME & GRATE	MHM	MOBILE HOME	S	SHEET	VEH	VEHICLE
C	COMMERCIAL BUILDING	FRWAY	FREEWAY	MOD	MODIFIED	SH	SHOULDER	VP	VENT PIPE
CE	COMMERCIAL ENTRANCE	GAL	GALLON	MFT	MOTOR FUEL TANK	SHLD	SIDEWALK OR SOUTHWEST	VERT	VERTICAL
CONC	CONCRETE	GALV	GALVANIZED	N & BC	NAIL & BOTTLE CAP	SW	SIGNAL	VC	VERTICAL CURVE
CONST	CONSTRUCT	G	GARAGE	N & C	NAIL & CAP	SIG	SIGNAL	VPC	VERTICAL POINT OF CURVATURE
CONTD	CONTINUED	GM	GAS METER	N & W	NAIL & WASHER	SOD	SODDING	VPI	VERTICAL POINT OF INTERSECTION
CONT	CONTINUOUS	GV	GAS VALVE	NC	NORMAL CROWN	SM	SOLID MEDIAN	VPT	VERTICAL POINT OF TANGENCY
COR	CORNER	GIS	GEOGRAPHICAL INFORMATION SYSTEM	NB	NORTHBOUND	SB	SOUTHBOUND	WM	WATER METER
CORR	CORRUGATED	GRAN	GRANULAR	NE	NORTHEAST	SE	SOUTHEAST	WV	WATER VALVE
CNP	CORRUGATED METAL PIPE	GR	GRATE	NW	NORTHWEST	SPL	SPECIAL	WMAN	WATER MAIN
CNTY	COUNTY	GRVL	GRAVEL	Q/S	OFFSET	SO	SPECIAL DITCH	WB	WESTBOUND
CH	COUNTY HIGHWAY	GND	GROUND	O&C	OR AND CHIP	SO FT	SQUARE FEET	WILDFL	WILDFLOWERS
CSE	COURSE	GUT	GUTTER	OLD	OPEN LID	m²	SQUARE METER	W	WITH
XSECT	CROSS SECTION	GP	GUY POLE	PAT	PATTERN	mm²	SQUARE MILLIMETER	WO	WITHOUT
m³	CUBIC METER	GW	GUY WIRE	PVD	PAVED	SO YD	SQUARE YARD		
mm³	CUBIC MILLIMETER	HM	HANDHOLE	PVMT	PAVEMENT	STB	STABILIZED		

Illinois Department of Transportation	
DESIGNED BY	2021
ENGINEERED BY	2021
APPROVED BY	2021
ENGINEER OF PUBLIC AND ENVIRONMENT	

DATE	REVISIONS
1-1-21	Updated fonts, abbreviations and symbols.
1-1-19	Added new symbols.

## STANDARD SYMBOLS, ABBREVIATIONS AND PATTERNS

(Sheet 1 of 9)

### STANDARD 000001-08

[illegible]





LIGHTING (cont'd.)		PAVEMENT MARKINGS		STANDARD SYMBOLS, ABBREVIATIONS AND PATTERNS	
EX	PR	EX	PR	(Sheet 4 of 9)	
Full Point		Handicap Symbol		STANDARD SYMBOLS, ABBREVIATIONS AND PATTERNS (Sheet 4 of 9)	
Handhole		RR Crossing			
Heavy Duty Handhole		Raised Marker Amber 1 Way		STANDARD SYMBOLS, ABBREVIATIONS AND PATTERNS (Sheet 4 of 9)	
Junction Box		Raised Marker Amber 2 Way			
Light Unit Comb.		Raised Marker Crystal 1 Way		STANDARD SYMBOLS, ABBREVIATIONS AND PATTERNS (Sheet 4 of 9)	
Electrical Ground		Two Way Turn Left			
Traffic Flow Arrow		Shoulder Diag. Pattern		STANDARD SYMBOLS, ABBREVIATIONS AND PATTERNS (Sheet 4 of 9)	
High Mast Pole (Pole Size)		Slip-Dash White			
Light Unit:-		Slip-Dash Yellow		STANDARD SYMBOLS, ABBREVIATIONS AND PATTERNS (Sheet 4 of 9)	
Keyed Long. Joint		Stop Line			
Keyed Long. Joint w/Flt Bars		Solid Line		STANDARD SYMBOLS, ABBREVIATIONS AND PATTERNS (Sheet 4 of 9)	
Sawed Long. Joint w/Flt Bars		Double Centerline			
Bluminous Shoulder		Dotted Lines		STANDARD SYMBOLS, ABBREVIATIONS AND PATTERNS (Sheet 4 of 9)	
Bluminous Taper					
Stallied Driveway				STANDARD SYMBOLS, ABBREVIATIONS AND PATTERNS (Sheet 4 of 9)	
Widering					

ILLINOIS DEPARTMENT OF TRANSPORTATION		ISSUED 1-1-97
DESIGNED BY	2011	
APPROVED BY	2011	
CHECKED BY	2011	

Illinois Department of Transportation		ISSUED 1-1-97
DESIGNED BY	CHIEF ENGINEER	
APPROVED BY	CHIEF ENGINEER	
PROJECT NO. 1-1-97		

# PAVEMENT MARKINGS (cont'd.)

EX

PR

CL 2Ln 2Way  
RSPM 12.2 m (40') o.c.

CL 2Ln 2Way  
RSPM 8.0' (24.4 m) o.c.

CL Multilane Div.  
RSPM 40' (12.2 m) o.c.

CL Multilane Div.  
RSPM 8.0' (24.4 m) o.c.

CL Multilane Div. Dst.  
RSPM 8.0' (24.4 m) o.c.

CL Multilane Undiv.

Two Way Turn Left Line

Urban Combination Left

Urban Combination Right

Urban Left Turn Arrow

Urban Right Turn Arrow

Urban Left Turn Only

Urban Right Turn Only

Urban Thru Only

Illinois Department of Transportation		ISDIT 1-1-97
DATE	PROJECT	301
APPROVED	DESIGNED BY	PROJECT MANAGER
FOR THE ILLINOIS DEPARTMENT OF TRANSPORTATION		

Urban LT & RT Turn Arrow

Urban Thru Arrow



ONLY

ONLY

ONLY



## RAILROAD ITEMS

EX

PR

Abandoned Railroad



Railroad



Railroad Point



Control Box

Crossing Gate

Flashing Signal

Railroad Cant. Mast Arm

Crossbuck

## REMOVAL ITEMS

EX

PR

Removal Tick

Bituminous Removal

Hash Pattern

Tree Removal Single

## RIGHT OF WAY ITEMS

EX

PR

Future ROW Corner Monument

ROW Marker

ROW Line

Easement

Temporary Easement

## STANDARD SYMBOLS, ABBREVIATIONS AND PATTERNS (Sheet 3 of 9)

STANDARD 000001-08

**PAVEMENT MARKINGS**  
(contd.)

EX

Urban U-Turn

Urban Combined U-Turn

Rural Combination Left

Rural Combination Right

Rural Left Turn Arrow

Rural Right Turn Arrow

Rural Left Turn Only

Rural Right Turn Only

Rural Thru Only

Rural Thru Arrow

Rural Lt & Rt Turn Arrow

Bike Lane Symbol

Bike Lane Text

Bike Path Shared

Bike Shared Roadway

Lane Drop Symbol

PR



ONLY ONLY ONLY

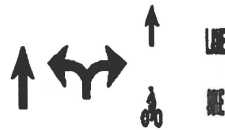

**STANDARD SYMBOLS,  
ABBREVIATIONS  
AND PATTERNS**  
(Sheet 6 of 9)

STANDARD 000001-06

Illinois Department of Transportation	
Project 1	2021
FUNDING: STATE FUND - 2021	
FUNDING: STATE FUND - 2021	
FUNDING: STATE FUND - 2021	

Wrong Way Arrow

# RIGHT OF WAY ITEMS (contd.)

	EX	PR
Access Control Line	— — — — —	— AC — — — — —
Access Control Line & ROW	— — — — — AC — — — — —	— — — — — AC — — — — —
Access Control Line & ROW with Fence	— — — — — AC — — — — —	— — — — — AC — — — — —
Excess ROW Line		— XS — — — — —

## ROADWAY PLAN ITEMS

	EX	PR
Cable Barrier		
Concrete Barrier		
Edge of Pavement	— — — — —	— — — — —
Bit Shoulders, Medians and C&G Line	— — — — —	— — — — —
Aggregate Shoulder	— — — — —	— — — — —
Sidewalks, Driveways	— — — — —	— — — — —
Guardrail		
Guardrail Post	o	o
Traffic Sign		
Corrugated Median		
Impact Attenuator		
North Arrow with District Office (Half Size)		
Match Line		STA. 45+00
Slope Limit Line	— — — — —	
Typical Cross-Section Line	— — — — —	— — — — —

# ROADWAY PROFILES

	EX	PR
P.I. Indicator	•	•
Point Indicator	•	•
Earthworks Balance Point		
Begin Point		
Vert. Curve Data	VPI = ELEV = L = E =	VPI = ELEV = L = E =
Ditch Profile Left Side	— — — — —	— — — — —
Ditch Profile Right Side	— — — — —	— — — — —
Roadway Profile Line	— — — — —	— — — — —
Storm Sewer Profile Left Side	— — — — —	— — — — —
Storm Sewer Profile Right Side	— — — — —	— — — — —

## SIGNING ITEMS

	EX	PR
Conc. Drum or Barricade		o
Barricade Type II		
Barricade Type III		
Barricade With Edge Line		
Flashing Light Sign		
Panels I		
Panels II		
Direction of Traffic		
Sign Flag (Half Size)		

# SIGNING ITEMS (contd.)

	EX	PR
Reverse Left W1-4L (Half Size)		
Reverse Right W1-4R (Half Size)		
Two Way Traffic Sign W6-3 (Half Size)		
Detour Ahead W20-2(O) (Half Size)		
Left Lane Closed Ahead W20-5L(O) (Half Size)		
Right Lane Closed Ahead W20-5R(O) (Half Size)		
Road Closed Ahead W20-3(O) (Half Size)		
Road Construction Ahead W20-1(O) (Half Size)		
Single Lane Ahead (Half Size)		
Transition Left W4-2L (Half Size)		
Transition Right W4-2R (Half Size)		

Illinois Department of Transportation

DESIGNED BY: [Signature] 2021

CHECKED BY: [Signature] 2021

APPROVED BY: [Signature] 2021

DATE: 1-1-21

**STANDARD SYMBOLS,  
ABBREVIATIONS  
AND PATTERNS**

(Sheet 7 of 9)

STANDARD 000001-08



# SIGNING ITEMS (contd.)

EX

PR

One Way Arrow Lrg. W1-6-(O)  
(Half Size)



Two Way Arrow Large W1-7-(O)  
(Half Size)



Detour M4-10L-(O)  
(Half Size)



Detour M4-10R-(O)  
(Half Size)



One Way Left R6-1L  
(Half Size)



One Way Right R6-1R  
(Half Size)



Left Turn Lane R3-1100L  
(Half Size)



Keep Left R4-7AL  
(Half Size)



Keep Left R4-7BL  
(Half Size)



Keep Right R4-7AR  
(Half Size)



Keep Right R4-7BR  
(Half Size)



Stop Here On Red R10-6-AL  
(Half Size)



Stop Here On Red R10-6-AR  
(Half Size)



No Left Turn R3-2  
(Half Size)



No Right Turn R3-1  
(Half Size)



Road Closed R11-2  
(Half Size)



Road Closed Thru Traffic R11-2  
(Half Size)



Illinois Department of Transportation	
PASSED BY <u>WLB</u>	REVIEWED BY <u>WLB</u>
DATE <u>1/1/01</u>	DATE <u>1/1/01</u>
ILLINOIS DEPARTMENT OF TRANSPORTATION	

# STRUCTURES ITEMS

EX

PR

Box Culvert Barrel



Box Culvert Headwall



Bridge Pier



Bridge



Retaining Wall



Temporary Sheet Piling



# TRAFFIC SHEET ITEMS

EX

PR

Cable Number



Left Turn Green



Left Turn Yellow



Signal Backplate



Signal Section 8" (200 mm)



Signal Section 12" (300 mm)



Walk/Don't Walk Letters



Walk/Don't Walk Symbols



# TRAFFIC SIGNAL ITEMS

EX

PR

Galv. Steel Conduit



Underground Cable



Detector Loop Line



Detector Loop Large



Detector Loop Small



Detector Loop Quadrupole



**STANDARD SYMBOLS,  
ABBREVIATIONS  
AND PATTERNS**

(Sheet 8 of 9)

STANDARD 000001-08

TRAFFIC SIGNAL ITEMS (cont'd.)		UNDERGROUND UTILITY ITEMS		ABANDONED		UTILITY ITEMS (cont'd.)	
EX	PR	EX	PR	EX	PR	EX	PR
Detector Backway		Cable TV		CTV		Traffic Signal	
Aluminum Mast Arm		Electric Cable		E		Traffic Signal Control Box	
Steel Mast Arm		Fiber Optic		FO		Water Meter	
Veh. Detector Magnetic		Gas Pipe		G		Water Meter Valve Box	
Conduit Splice		Oil Pipe		O		Profile Line	
Controller		Sanitary Sewer		S		Aerial Power Line	
Gulch Junction		Telephone Cable		T			
Wood Pole		Water Pipe		W			
Temp. Signal Head		UTILITIES ITEMS		EX	PR	VEGETATION ITEMS	
Handhole		Controller		C		Deciduous Tree	
Double Handhole		Double Handhole		D		Bush or Shrub	
Heavy Duty Handhole		Fire Hydrant		F		Evergreen Tree	
Junction Box		GuyWire or Deadman Anchor		A		Stump	
Ped. Pushbutton Detector		Handhole		H		Orchard/Nursery Line	
Ped. Signal Head		Heavy Duty Handhole		HD		Vegetation Line	
Power Pole Service		Junction Box		J		Woods & Bush Line	
Priority Veh. Detector		Light Pole		L			
Signal Head		Manhole		M		WATER FEATURE ITEMS	
Signal Head w/backplate		Monitoring Well (Gasoline)		W		Stream or Drainage Ditch	
Signal Post		Pipeline Warning Sign		P		Waters Edge	
Closed Circuit TV		Power Pole		PP		Water Surface Indicator	
Video Detector System		Power Pole with Light		PL		Water Point	
		Sanitary Sewer Cleanout		SC		Disappearing Ditch	
		Splice Box Above Ground		SB		Marsh	
		Telephone Splice Box Above Ground		TB		Marsh/Swamp Boundary	
		Telephone Pole		TP			

**STANDARD SYMBOLS, ABBREVIATIONS AND PATTERNS**  
(Sheet 9 of 9)

**STANDARD 000001-08**

ILLINOIS Department of Transportation  
MADE BY WJR 10/20/11  
APPROVED BY WJR 10/20/11  
PROJECT NO. 101

TRAFFIC SIGNAL ITEMS (cont'd.)		UNDERGROUND UTILITY ITEMS		ABANDONED		UTILITY ITEMS (cont'd.)	
EX	PR	EX	PR	EX	PR	EX	PR
Detector Backway		Cable TV	CTV	CTV	CTV	Traffic Signal	
Aluminum Mast Arm		Electric Cable	E	E	E	Traffic Signal Control Box	
Steel Mast Arm		Fiber Optic	FO	FO	FO	Water Meter	
Veh. Detector Magnetic		Gas Pipe	G	G	G	Water Meter Valve Box	
Conduit Splice		Oil Pipe	O	O	O	Profile Line	
Controller		Sanitary Sewer	SS	SS	SS	Aerial Power Line	
Gulch Junction		Telephone Cable	T	T	T		
Wood Pole		Water Pipe	W	W	W		
Temp. Signal Head		UTILITIES ITEMS		EX	PR	VEGETATION ITEMS	
Handhole		Controller	EX	PR	EX	EX	PR
Double Handhole		Double Handhole	EX	PR	EX	EX	PR
Heavy Duty Handhole		Fire Hydrant	EX	PR	EX	EX	PR
Junction Box		GuyWire or Deadman Anchor	EX	PR	EX	EX	PR
Ped. Pushbutton Detector		Handhole	EX	PR	EX	EX	PR
Ped. Signal Head		Heavy Duty Handhole	EX	PR	EX	EX	PR
Power Pole Service		Junction Box	EX	PR	EX	EX	PR
Priority Veh. Detector		Light Pole	EX	PR	EX	EX	PR
Signal Head		Manhole	EX	PR	EX	EX	PR
Signal Head w/backplate		Monitoring Well (Gasoline)	EX	PR	EX	EX	PR
Signal Post		Pipeline Warning Sign	EX	PR	EX	EX	PR
Closed Circuit TV		Power Pole	EX	PR	EX	EX	PR
Video Detector System		Power Pole with Light	EX	PR	EX	EX	PR
		Sanitary Sewer Cleanout	EX	PR	EX	EX	PR
		Splice Box Above Ground	EX	PR	EX	EX	PR
		Telephone Splice Box Above Ground	EX	PR	EX	EX	PR
		Telephone Pole	EX	PR	EX	EX	PR

STANDARD SYMBOLS, ABBREVIATIONS AND PATTERNS	(Sheet 9 of 9)
STANDARD 000001-08	

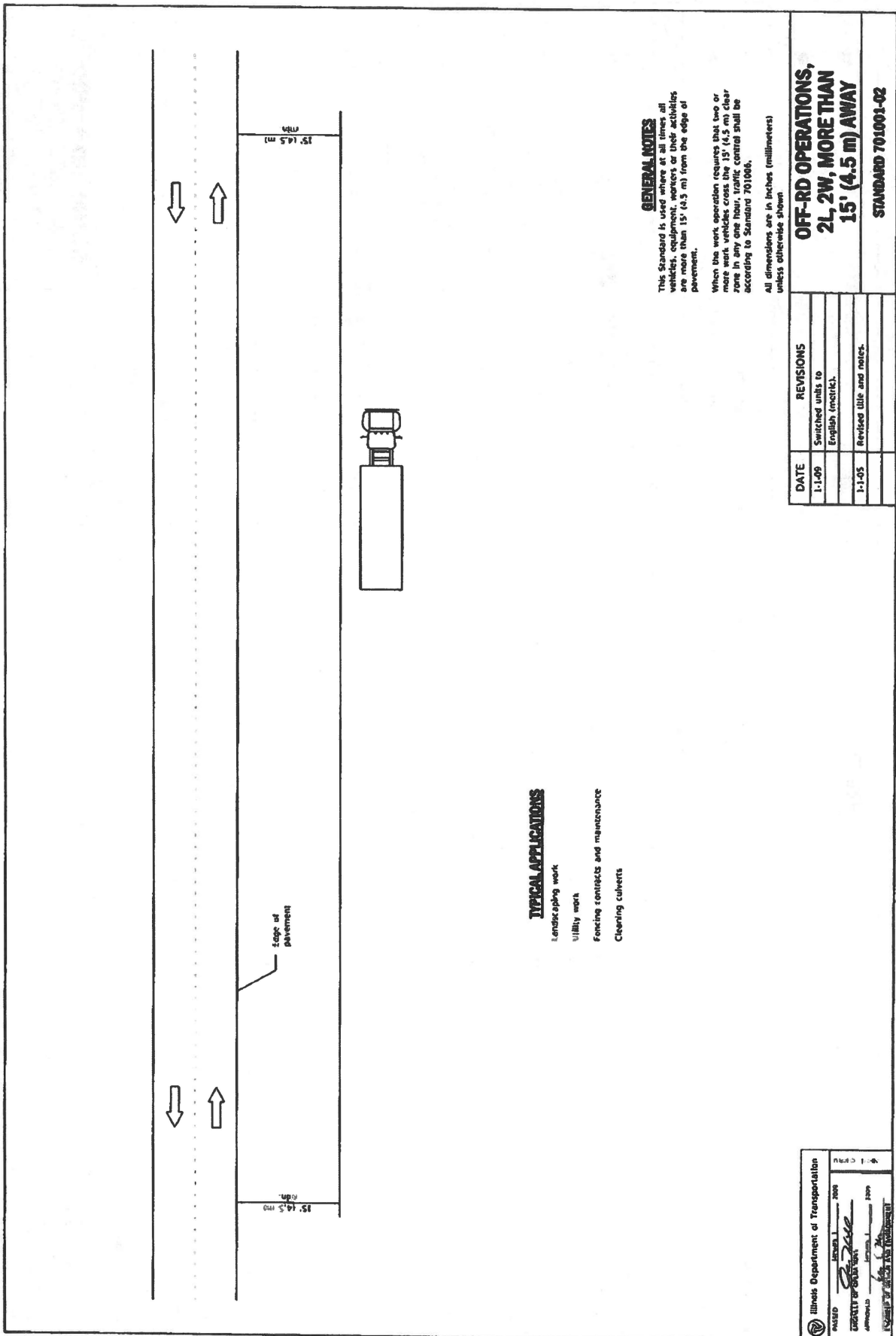

### TYPICAL APPLICATIONS

- Landscape work
- Utility work
- Fencing, contacts and maintenance
- Clearing culverts

### GENERAL NOTES

This Standard is used where at all times all vehicles, equipment, workers or their activities are more than 15' (4.5 m) from the edge of pavement.

When the work operation requires that two or more vehicles cross the 15' (4.5 m) clear zone, the work operation shall be conducted according to Standard 701006.

All dimensions are in inches (millimeters) unless otherwise shown.

DATE	REVISIONS
1-1-00	Switched units to English metric.
1-1-05	Revised title and notes.

**OFF-ROAD OPERATIONS,  
2L, 2W, MORE THAN  
15' (4.5 m) AWAY**

**STANDARD 701001-02**

Illinois Department of Transportation	
DESIGNED BY	DATE
CHECKED BY	DATE
APPROVED BY	DATE
ILLINOIS DEPARTMENT OF TRANSPORTATION	

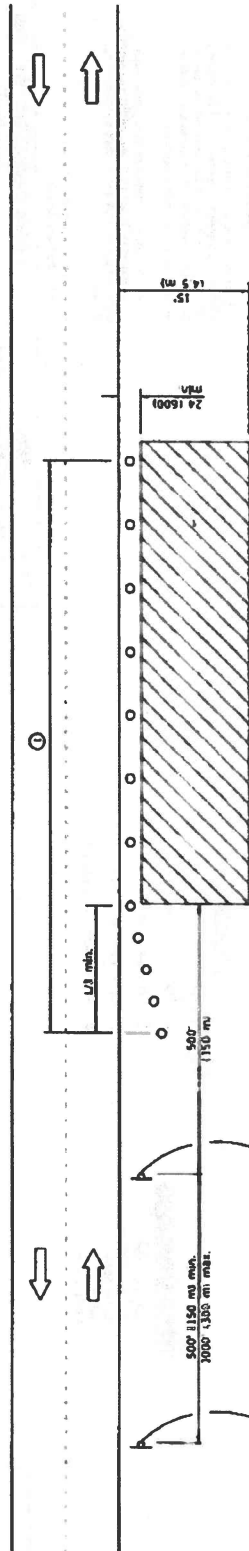

For contract  
construction  
projects

W20-100-40

For maintenance  
and utility  
projects

W20-100-40

W21-100-40

① When the work operation exceeds one hour cones, drums or barricades shall be placed at 25' (8 m) centers for L3 distance, and at 30' (10 m) centers through the remainder of the work area.

### TYPICAL APPLICATIONS

- Utility operations
- Culvert extensions
- Side slope changes
- General installation and maintenance
- Detector installation
- Shoulder repair
- Sign installation and maintenance

### SYMBOLS

- Work area
- Sign
- Cone, drum or barricade

### GENERAL NOTES

This Standard is used where any vehicle, equipment, workers or their activities will encroach in the area 15' (4.5 m) to 24' (600 mm) from the edge of pavement.

Calculate L as follows:

#### SPEED LIMIT

40 mph (70 km/h)  
or less:

English

Formula

Metric

WSP

L = 80

L = 150

45 mph (80 km/h)  
or greater:

English

Formula

Metric

WSP

L = 80

L = 150

W = Width of offset  
in feet (meters).

S = Normal posted speed  
in mph (km/h).

All dimensions are in inches (millimeters)  
unless otherwise shown.

**OFF-ROAD OPERATIONS, 2L, 2W,  
15' (4.5 m) TO 24' (600 mm)  
FROM PAVEMENT EDGE**

STANDARD 701008-06

DATE	REVISIONS
1-1-14	Revised workers sign
	Number to agree with
	Current MUTCD
1-1-13	Omitted text "WORKERS"
	sign.

Illinois Department of Transportation

DESIGNED BY: [Signature]  
CHECKED BY: [Signature]  
APPROVED BY: [Signature]  
DATE: 1-1-14

- ① Devices at 20' (6 m) centers in the taper.
- ② Cones at 25' (8 m) centers for the first 150' (45 m). Additional cones may be placed at 50' (15 m) centers. When drums or barricades are used, these intervals between devices may be doubled.

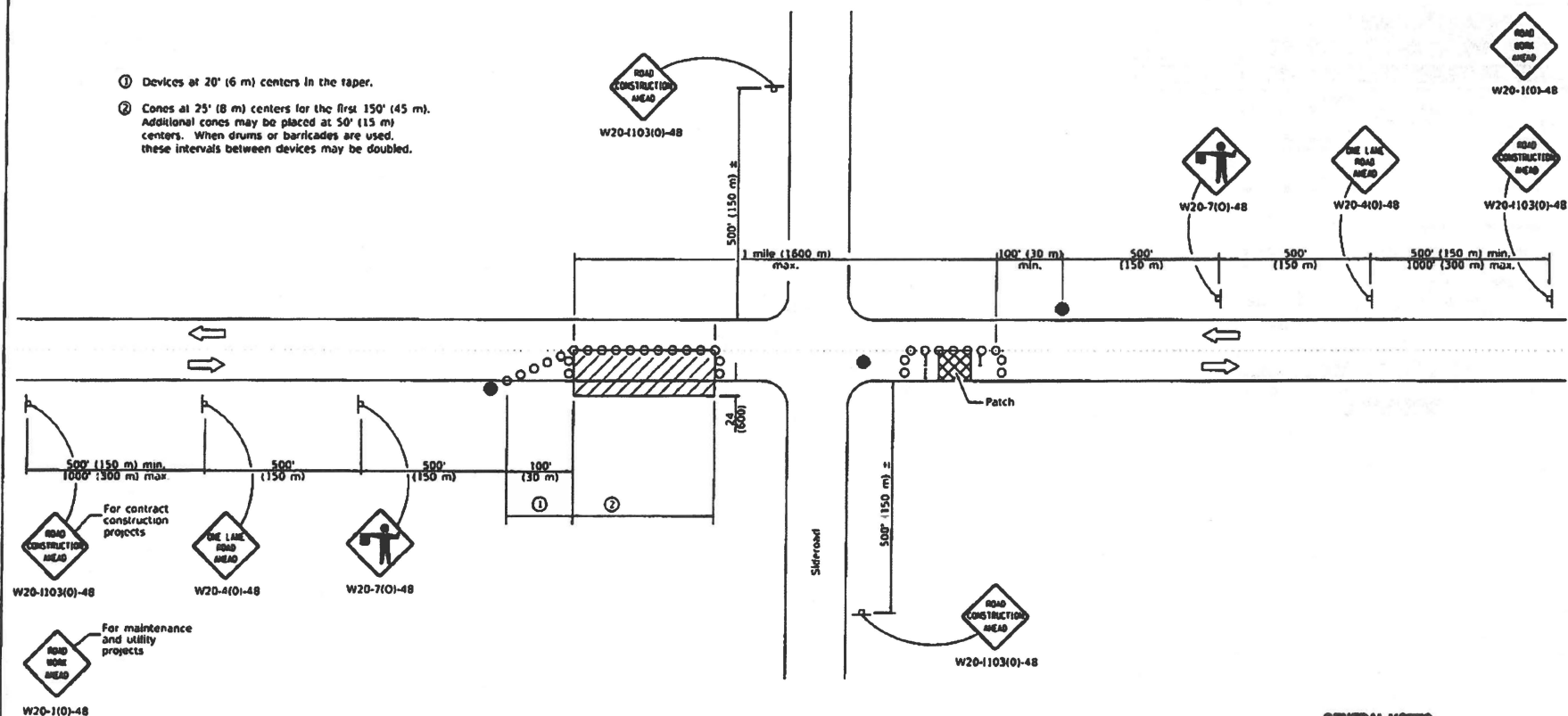

#### SYMBOLS

- Work area
- Sign
- Barricade or drum
- Cone, drum or barricade
- Flagger with traffic control sign

#### TYPICAL APPLICATIONS

Isolated patching  
Utility operations  
Storm sewer  
Culverts  
Cable placement

#### GENERAL NOTES

This Standard is used where at any time, any vehicles, equipment, workers or their activities will encroach in the area between the center line and a line 24' (600 mm) outside the edge of pavement for daylight operation.

When the distance between successive work areas exceeds 2000' (600 m), additional warning signs, flaggers, and taper shall be placed as shown.

All dimensions are in inches (millimeters) unless otherwise shown.

Illinois Department of Transportation

APPROVED: *[Signature]* January 1, 2019

CHIEF OF DIVISION OF HIGHWAYS AND BRIDGES

APPROVED: *[Signature]* January 1, 2019

CHIEF OF DIVISION OF CONSTRUCTION

DATE	REVISIONS
1-3-19	Revised device spacing in taper.
1-1-11	Revised flagger sign.

**LANE CLOSURE, 2L, 2W,  
DAY ONLY,  
FOR SPEEDS ≥ 45 MPH**

**STANDARD 701201-05**



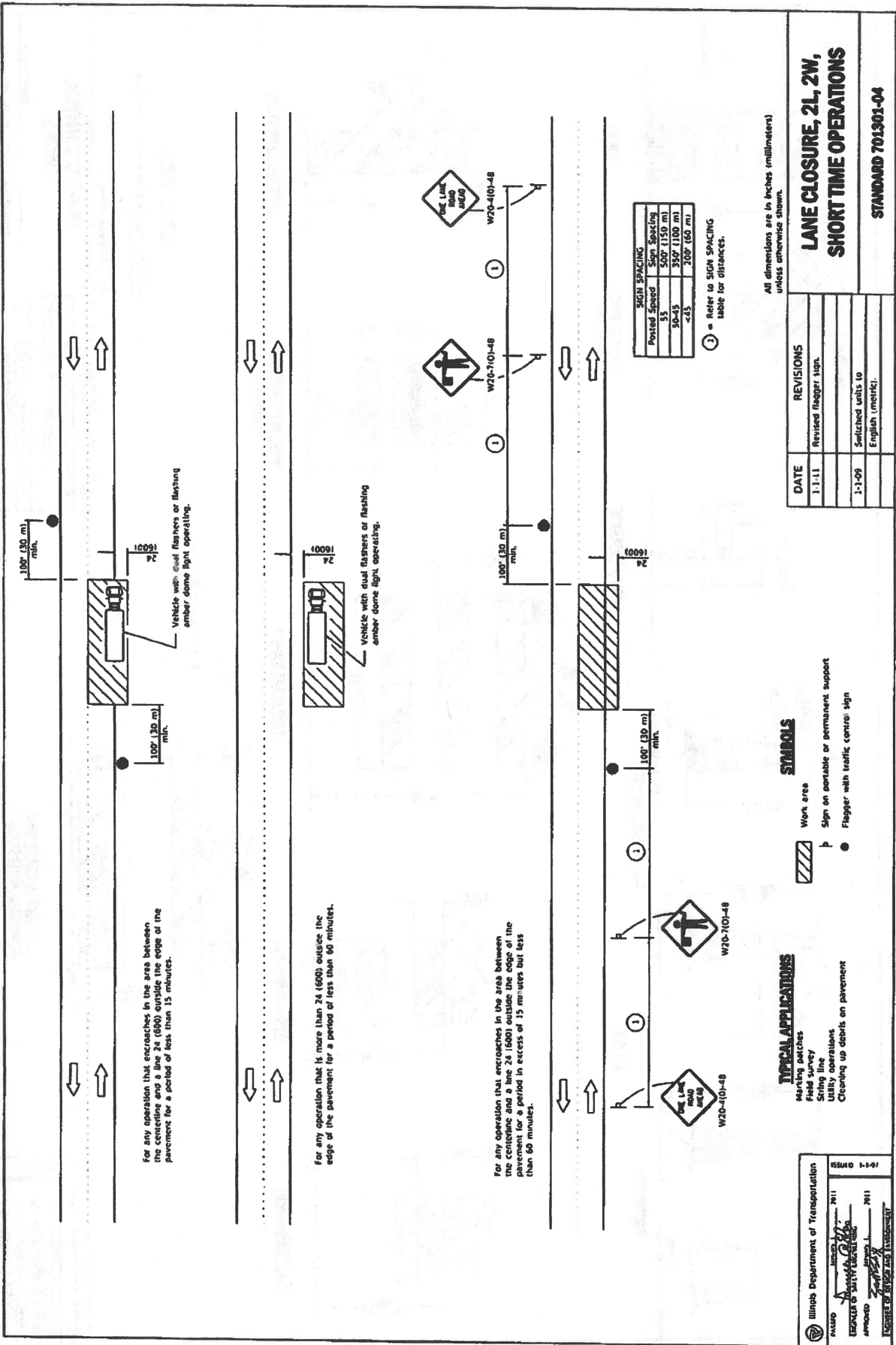

All dimensions are in inches (millimeters) unless otherwise shown.

Illinois Department of Transportation

PROJECT NO. 15140 1-1-07

DESIGNED BY: [Signature]

CHECKED BY: [Signature]

APPROVED BY: [Signature]

DATE: 1-1-07

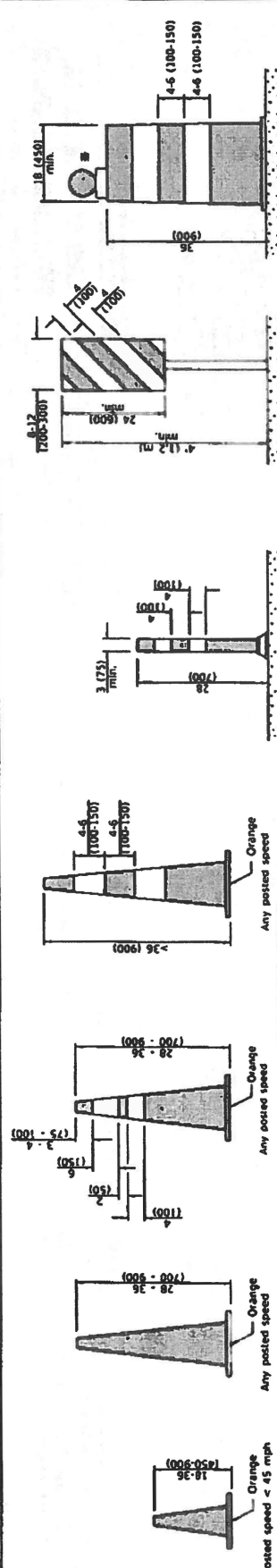

**CONES**

**DAY OR NIGHTTIME USE**

**DAYTIME USE**

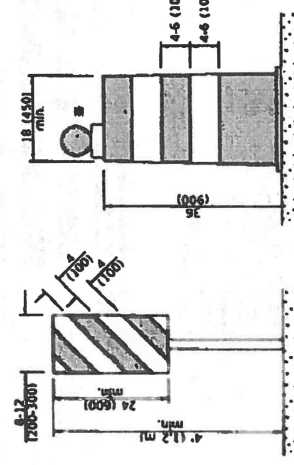

**VERTICAL PANEL POST MOUNTED**

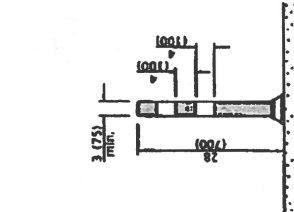

**TUBULAR MARKER**

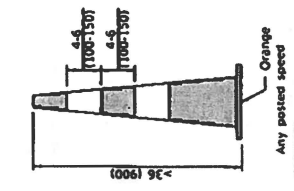

**DRUM**

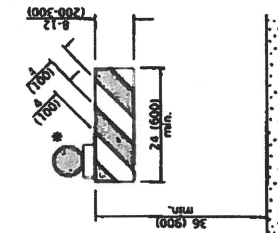

**TYPE I BARRICADE**

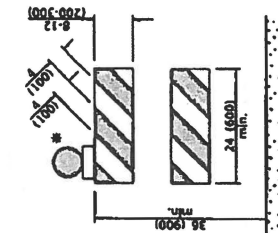

**TYPE II BARRICADE**

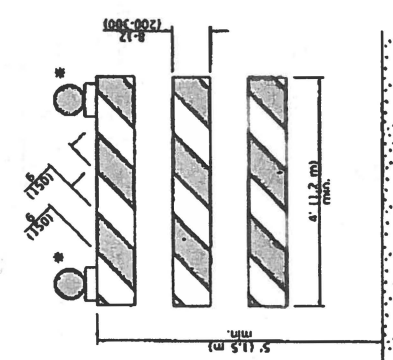

**TYPE III BARRICADE**

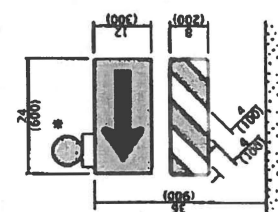

**DIRECTION INDICATOR BARRICADE**

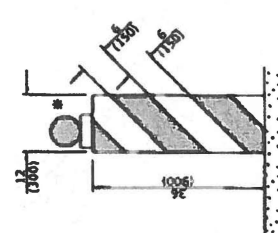

**VERTICAL BARRICADE**

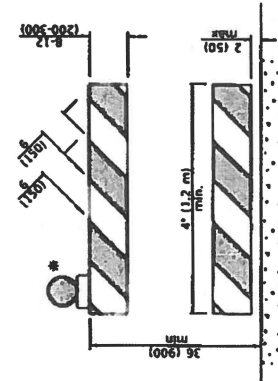

**DETECTABLE PEDESTRIAN CHANNELIZING BARRICADE**

**GENERAL NOTES**

All heights shown shall be measured above the pavement surface.  
All dimensions are in inches (millimeters) unless otherwise shown.

TRAFFIC CONTROL DEVICES	
DATE	REVISIONS
1-1-19	Revised cone usage and added cones > 36" (900 mm) height
1-1-18	Revised END WORK ZONE SPEED LIMIT sign from orange to white background.

(Sheet 1 of 3)

**STANDARD 701901-08**

Illinois Department of Transportation  
 DIVISION OF HIGHWAYS  
 PROJECT NO. \_\_\_\_\_  
 DRAWING NO. \_\_\_\_\_  
 DATE \_\_\_\_\_  
 DESIGNED BY \_\_\_\_\_  
 CHECKED BY \_\_\_\_\_  
 IN CHARGE \_\_\_\_\_

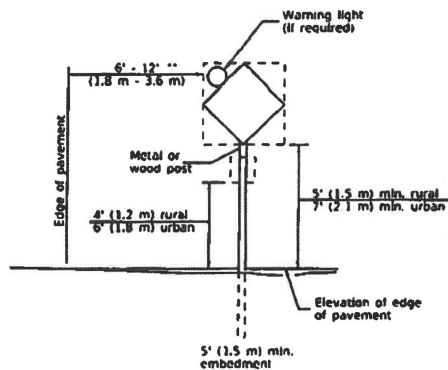

#### POST MOUNTED SIGNS

\*\* When curb or paved shoulder are present this dimension shall be 24 (600) to the face of curb or 6' (1.8 m) to the outside edge of the paved shoulder.



W12-1103-4846

#### WIDTH RESTRICTION SIGN

XX'-XX" width and X miles are variable.

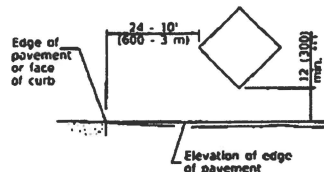

#### SIGNS ON TEMPORARY SUPPORTS

\*\*\* When work operations exceed four days, this dimension shall be 5' (1.5 m) min. If located behind other devices, the height shall be sufficient to be seen completely above the devices.

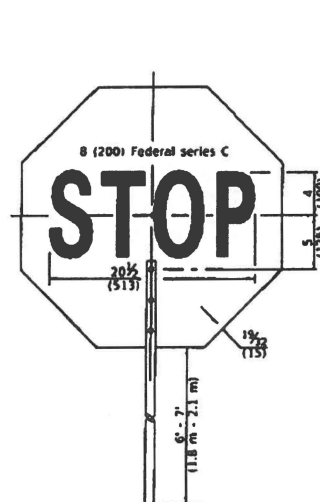

FRONT SIDE

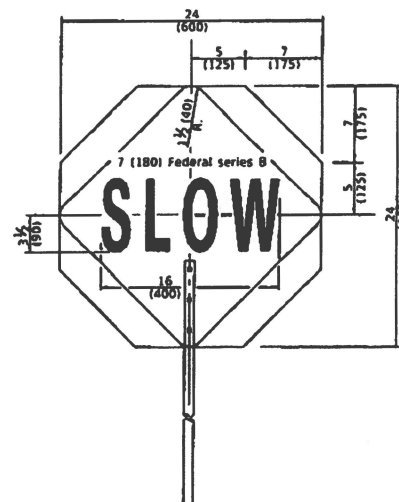

REVERSE SIDE

#### FLAGGER TRAFFIC CONTROL SIGN

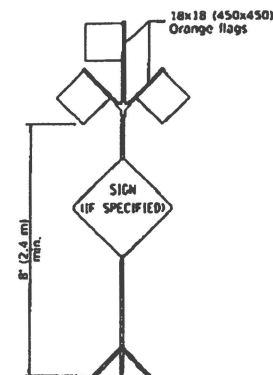

#### HIGH LEVEL WARNING DEVICE

ROAD  
CONSTRUCTION  
NEXT X MILES

G20-1104(0)-6036

END  
CONSTRUCTION

G20-1105(0)-6024

This signing is required for all projects 2 miles (3200 m) or more in length.

ROAD CONSTRUCTION NEXT X MILES sign shall be placed 500' (150 m) in advance of project limits.

END CONSTRUCTION sign shall be erected at the end of the job unless another job is within 2 miles (3200 m).

Dual sign displays shall be utilized on multi-lane highways.

#### WORK LIMIT SIGNING



W21-1115(0)-3618

R2-1-3648

R10-1108p-3618 \*\*\*\*

R2-1106p-3618

Sign assembly as shown on Standards or as allowed by District Operations.

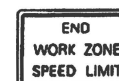

G20-1103-6036

This sign shall be used when the above sign assembly is used.

#### HIGHWAY CONSTRUCTION SPEED ZONE SIGNS

\*\*\*\* R10-1108p shall only be used along roadways under the jurisdiction of the State.

#### TRAFFIC CONTROL DEVICES

(Sheet 2 of 3)

STANDARD 701901-08

Illinois Department of Transportation	
APPROVED	2019
DESIGNED BY STATE HIGHWAY AND TRANSPORTATION ENGINEER	
APPROVED	2019
ILLINOIS DEPARTMENT OF TRANSPORTATION	



Local Public Agency	County	Section Number	Route
PESOTUM TOWNSHIP RD DISTRICT	Champaign	06-18408-00-SP	100N COUNTY ROAD

Funding Source: ☐ Motor Fuel Tax ☐ Township Bridge ☒ Other State Funds Grade Crossing Protection Fund

Indicate for each item: A for items approved, clear, or yes check the A box, and enter the date as applicable. For items exempt or not applicable, check the E box.

**ENVIRONMENTAL ISSUES:**

	E	A	Date
1 Section 6(f) Land and Water Conservation (LAWCON) Land Conversion	<input checked="" type="checkbox"/>	<input type="checkbox"/>	
2 Open Space Lands Acquisition and Development (OSLAD) Land Conversion	<input checked="" type="checkbox"/>	<input type="checkbox"/>	
3 Wetlands Compliance	<input checked="" type="checkbox"/>	<input type="checkbox"/>	
4 Historic Preservation/Cultural Compliance	<input checked="" type="checkbox"/>	<input type="checkbox"/>	
5 Threatened and Endangered Species/Natural Areas Compliance	<input checked="" type="checkbox"/>	<input type="checkbox"/>	
6 Farmland Conversion Impacts	<input checked="" type="checkbox"/>	<input type="checkbox"/>	
7 Special Waste Screening	<input checked="" type="checkbox"/>	<input type="checkbox"/>	
8 Other <span style="border: 1px solid black; display: inline-block; width: 600px; height: 1.2em; vertical-align: middle;"></span>	<input checked="" type="checkbox"/>	<input type="checkbox"/>	

**PROJECT STUDIES/REPORTS:**

1 Airport Coordination	<input checked="" type="checkbox"/>	<input type="checkbox"/>	
2 Railroad Coordination	<input checked="" type="checkbox"/>	<input type="checkbox"/>	
3 Intersection Design Study (IDS)	<input checked="" type="checkbox"/>	<input type="checkbox"/>	
4 Bridge Condition Report (BCR)	<input checked="" type="checkbox"/>	<input type="checkbox"/>	
5 Preliminary Bridge Design and Hydraulic Report (PBDHR)	<input checked="" type="checkbox"/>	<input type="checkbox"/>	
6 Bridge Asbestos Determination	<input checked="" type="checkbox"/>	<input type="checkbox"/>	
7 Drainage Studies	<input checked="" type="checkbox"/>	<input type="checkbox"/>	
8 Geotechnical Report	<input checked="" type="checkbox"/>	<input type="checkbox"/>	
9 Commitments	<input checked="" type="checkbox"/>	<input type="checkbox"/>	
10 Design Exceptions	<input checked="" type="checkbox"/>	<input type="checkbox"/>	
11 Maximum Extent Practical for Americans with Disabilities Act (MEP-ADA)	<input checked="" type="checkbox"/>	<input type="checkbox"/>	
12 Other <span style="border: 1px solid black; display: inline-block; width: 600px; height: 1.2em; vertical-align: middle;"></span>	<input checked="" type="checkbox"/>	<input type="checkbox"/>	

**RIGHT-OF-WAY**

<input checked="" type="checkbox"/>	<input type="checkbox"/>	
-------------------------------------	--------------------------	--

**PERMITS**

1 NPDES <input type="checkbox"/> ILR10 Permit # <span style="border: 1px solid black; display: inline-block; width: 100px; height: 1.2em; vertical-align: middle;"></span>	<input checked="" type="checkbox"/>	<input type="checkbox"/>	
<input type="checkbox"/> ILR40 Permit # <span style="border: 1px solid black; display: inline-block; width: 100px; height: 1.2em; vertical-align: middle;"></span>			
2 Section 404 (USACE) <span style="border: 1px solid black; display: inline-block; width: 120px; height: 1.2em; vertical-align: middle;"></span>	<input checked="" type="checkbox"/>	<input type="checkbox"/>	
3 Section 401 Water Quality Certification	<input checked="" type="checkbox"/>	<input type="checkbox"/>	
4 Section 9 (Coast Guard)	<input checked="" type="checkbox"/>	<input type="checkbox"/>	
5 Burning of Landscape Waste	<input checked="" type="checkbox"/>	<input type="checkbox"/>	
6 Other <span style="border: 1px solid black; display: inline-block; width: 600px; height: 1.2em; vertical-align: middle;"></span>	<input checked="" type="checkbox"/>	<input type="checkbox"/>	

The above information is certified to be true and correct.

Prepared By	Date
JOHN L. COOPER	07/18/22
Title	
Assistant County Engineer	

Local Public Agency Approval	Date
	1/3/23